

Bitter Lake Reservoir Open Space Project

Engagement #1 Summary

Project Overview

Seattle Public Utilities (SPU) is replacing the existing reservoir with a concrete tank that has a smaller footprint. This design provides additional open space for an expanded park for the community. Seattle Parks and Recreation (SPR) is leading the park and open space design in coordination with SPU, the Office of Arts and Culture and the Department of Neighborhoods. This project will incorporate elements of the existing park together with new recreation amenities, public art, and a potential P-Patch expansion.

Engagement Process

This first phase of engagement focused on sharing the project and hearing from community members about their current experiences with the Bitter Lake Reservoir Park, what they would like to see in the future, and what concerns and priorities they have. Community feedback will help shape the three park design concepts that the project team will develop. The community will have another opportunity to provide feedback on the three park design concepts to help refine them and select a final design.

The following sections are a summary and key themes of the three engagement activities: a focus group, in-person open house, and online survey.

Focus Group

The focus group was held on Thursday, October 26, 2023 from 3:00 – 4:00 p.m. at the Bitter Lake Community Center in the Family Room. The focus group provided an opportunity for community members to learn more about the project and to provide their perspectives, priorities, feedback, concerns, and ideas on the park and open space design (see Appendix A for the focus group summary memo).

Through a facilitated conversation, participants shared what they felt was currently missing at the Bitter Lake Reservoir park and open space.

- Not enough P-patch space
 - Where can we expand to?
 - Don't want to disturb the current patch
 - Would be nice to have edible plants demonstrations for the community
- Expand the playground
- Basketball court
- Accessible paths
- Need sitting benches
- More lighting
- Mountain bike paths
- Amphitheater
- Some level ground for informal play
- Plant more trees, to help with cooling

- A path or loop around the park that's protected
- A dog park
 - Perhaps on the west side to offer more activity on that side of the park for the residents along Fremont Ave N
 - Not welcomed idea by one resident who lives there because of the noise
 - Could consider a buffer between the dog park and residents
- A sound park
- Spray park
- Would like a restroom, but recognize it's costly and requires maintenance
- Parking
 - Maybe time-limited spots
- A sledding hill

When asked what made participants feel safe, they responded having open space where you could see far and keep an eye on children playing (e.g., Yesler Terrace Park), clean space, activity and people around, and overhead and pathway lighting. Additionally, participants asked the project team to take a look at storm water plants and trim those that are overgrown because they are blocking access to the park and to be mindful of mature plan heights so that trees do not shade out the P-Patch. A participant asked for more accessible P-Patch spots, especially for people who are older or using mobility devices.

In closing, the project team shared they would keep the participants informed of the next round of engagement (likely early 2024), that there was a public survey open until November 10 (this was extended to November 20), and thanked everyone for their time and insights. A participant asked if they could invite other interested people, particularly younger people and families, to the next focus group, and the project team enthusiastically encouraged them to please do so.

In-person Open House

The open house was held on Thursday, October 26, 2023, from 6:00 – 8:00 p.m. at the Bitter Lake Community Center in the Multipurpose Room. The open house provided an opportunity for community members to learn more about the project and to provide their perspectives, priorities, feedback, concerns, and ideas on the park and open space design. In total, 17 people visited the open house, including six youth from the Bitter Lake Community Center.

Station set-up:

Station 1: Welcome and sign in

Station 2: Existing conditions at Bitter Lake Reservoir display boards

Station 3: Site analysis and photo display boards with proposed programming/improvement opportunities that participants could vote for with sticker dots (see Appendix B for comments left on boards and stick dot counts)



Figure 1. Display boards with proposed programming/improvement opportunities with sticker dots.

Topic	Comment Summary
Site Analysis – Current site	<ul style="list-style-type: none"> ▪ Safety: <ul style="list-style-type: none"> ○ Consider how to keep it safe for kids/families ○ Design to deter encampments ▪ Maintenance: <ul style="list-style-type: none"> ○ Site needs more trash cans – lots of trash ○ Currently lots of dog poop along Linden Ave ▪ Site considerations: <ul style="list-style-type: none"> ○ Please use a low carbon, climate friendly concrete ○ Use exercise equipment – 2 people
Site Analysis - New reservoir	<ul style="list-style-type: none"> ▪ Please leave the maintenance buildings unchanged – could even enlarge them
Improvement Opportunities	<ul style="list-style-type: none"> ▪ Programming ideas: <ul style="list-style-type: none"> ○ On nature learning boards, have the explanation in audio and braille as well ○ Looped walking path to walk dog ○ Spray pad ○ Pickleball ▪ Dots on the image boards: <ul style="list-style-type: none"> ○ Dog off-leash area – 1 dot ○ Expand play opportunities (nature-based, traditional, etc.) – 4 dots ○ Sensory garden and/or children's garden – 2 dots ○ Picnicking, lawn games, and other informal activities – 4 dots ○ Outdoor games (e.g., chess board, ping-pong table) – 4 dots ○ Outdoor classroom / learning opportunities / interpretive signage – 2 dots ○ Sledding hill – 5 dots ○ Bike trails/ Pump track / BMX track – 4 dots ○ Kids adventure track (for younger kids) – 2 dots ○ Outdoor fitness equipment – 1 dot ○ Expanded community garden / P-Patch – 3 dots ○ Shelter(s) for smaller community gatherings – 2 dots ○ Outdoor grills / BBQ / picnic tables – 4 dots ○ Community events / amphitheater – 11 dots ○ Slide – 6 dots ○ Bike parking/ bike maintenance / hydration station – 0 dots ○ Zip-lines, climbing walls, ropes courses, etc. (for all ages) – 15 dots ○ Informal seating – 5 dots ○ Formal seating – 0 dots ○ Courts for tennis, basketball, volleyball, etc. – 7 dots ○ Food forest (e.g., like Beacon Hill) – 1 dot ○ Walking paths / trails (paved & unpaved) – 9 dots ○ Formal running track/paths (e.g., ¼ mile or ½ mile loops around reservoir) – 2 dots ○ Land art and topography (Kite hill) – 6 dots ○ Ball wall – 1 dot ○ Gateway art – 1 dot

Station 4: Seattle Public Utilities table with project information



Figure 2. Seattle Public Utilities table and information

Station 5: Interactive Bitter Lake Reservoir Park sandbox model and kids table with coloring materials

Primary desires expressed for public art direction via survey and discussion at the October 26 Open House: The artwork(s) should be:

- Eye catching/colorful
- Reflect the diversity of the neighborhood
- Tell the story of the water

Multiple people also expressed a desire for more seating and shade protection- which could connect to art amenities.

Earthwork shapes that people sculpted at the sandbox model experimented with lots of opportunity for play such as mounds for climbing and lookout points. Others also experimented with creating earthwork forms that interacted with potential water elements.



Figure 3. Bitter Lake Reservoir sandbox model

Station 6: Comment forms and printed surveys

See Appendix C for the one comment form



Figure 4. Participants conversing with project team staff.

Survey

The seven-question survey (see Appendix D for the survey questions and responses) was hosted online from October 26 to November 20 on SurveyMonkey and translated into Amharic, traditional Chinese, and Spanish based on recommendations from past engagement by SPU. A total of 154 people took the survey.

When asked **how they use the existing park** (multiple selections allowed), the majority of respondents selected “Use pathways to walk, run, bike, roll, etc.” (37.7% of respondents selected this activity) and “Play sports or games” (34.9% of respondents selected this activity), followed by “To be physically active and exercise” (30.1% of respondents selected this activity). Of the comments left when respondents selected “Other,” 75.0% mentioned pickleball, as something they play or want to play at the park. Other comments mentioned not visiting or using the park much because of lack of space, using the park as a rest stop while bicycling or to exercise their dog, and to tan.

The next survey question asked respondents **which recreation features and activities they most want to see included in the existing and expanded park and to rate their interest level**. Respondents had the highest interest in paved and unpaved walking paths/trails (weighted average of 3.8), courts for tennis, basketball, volleyball, etc. (weighted average of 3.6), formal running track/paths (weighted average of 3.2), and expanding the playground (weighted average of 3.2). Of the 68 comments received when respondents selected “Other,” nearly three-fourths (73.5%) mentioned pickleball courts, specifically dedicated, covered, and with lights. Other comment themes included wanting safe open space for formal and informal play and use, expansion of the P-Patch, and specific activity uses such as a wading pool and splash park, skate park, sand volleyball court, and cycling.

Survey respondents were then asked to **think about the best parks they have visited and what makes them their favorite or stand out and what makes them feel safe**. Key themes of the 107 comments included:

- Outdoor activities and recreation
 - Pickleball was mentioned often, specifically well-maintained and lit courts
 - Space for play, picnics and gatherings, and to enjoy the outdoors
 - Outdoor fitness equipment
 - Paths and trails for multiple uses
 - Pump track
 - Spray park
 - Art integrated into recreation, like a salmon slide
- Trees and green spaces
 - Plentiful trees and natural green spaces to relax and play in nature
 - A nice view or landscaping
- Park facilities
 - Restrooms
 - Trash cans
 - Covered areas/shelters
 - Artwork
- Safety and security
 - Adequate lighting around park and parking area
 - Clean spaces and restrooms
 - Open sight lines
 - People and activity in the area
 - No encampments or use of drugs in the area
 - Regular security patrols
- Accessibility and inclusivity
 - Seating areas
 - Connections to park, for example so people can bike to it
 - Mix of activities for people of all abilities, ages, and background; the neighborhood is very diverse
 - Accessible playground (currently the Bitter Lake Reservoir playground has woodchips and that can be difficult to navigate for people with mobility devices)
 - Near by businesses to visit and support
- Specific parks in the Seattle and greater area respondents mentioned they enjoyed
 - Greenlake Park
 - Seward Park
 - Jefferson Park
 - Laurelhurst Park
 - Mt. Baker Park
 - Carkeek Park
 - Miller Park
 - Volunteer Park
 - Discovery Park
 - Golden Gardens
 - Maple Leaf Reservoir
 - Hamlin Park
 - North Acres Park
 - Loyal Heights
 - Marymoor Park

- Rainier Beach Playfield
- Hazel Miller Park
- Magnuson Park
- Perrigo Park
- Hartman Park
- Juanita Park
- Respondents also listed several parks in other geographies specifically for their pickleball courts

Respondents shared **additional considerations** for the design team for the expanded Bitter Lake Reservoir Park and Open Space. Key themes of the 81 comments included:

- Additional features for outdoor activities and recreation
 - A desire for dedicated pickleball courts, especially well-lit, covered ones
 - All weather soccer field and sand volleyball court
 - Covered picnic area
 - Paths and trails for multiple activities, such as walking, running, cycling, rolling, etc.
 - Wading pool or spray park
 - Several respondents commented that they would not like a dog park along the west side of the park
 - Nature play for children, rather than elaborate toy sets
 - Dog park with paw washing station
- Park facilities
 - EV charging stations
 - Restrooms, with sharps/biohazards bin
 - Trash cans
 - Parking spaces
 - Free library/pantry
- Safety and security
 - Safety features such as fencing with smaller gaps, security cameras, or security patrols to deter crime
 - Keep the fence on the west side of the park and protect the privacy of residents living along the west side of the park
 - Adequate lighting
 - Design to have open sight lines
 - Prevent encampments
- Garden and natural spaces
 - Avoid impacts to the current P-Patch during the expansion and expand it
 - Add a perennial edible landscape/food forest; integrate the food forest into a landscape park model
 - More trees and shaded areas
- Accessibility
 - Need accessible areas and spaces for people of all abilities, ages, and backgrounds
 - Connect bike trails to the park

The final three survey questions asked about respondents' demographics information. The majority of respondents shared that they had a household member who was 65 years old or older (32.0%). Over a

third of households (41.3%) include a person who is 18 years old or younger. The majority of respondents identified (multiple responses were allowed) as white or Caucasian (70.6%) with the next largest group of respondents identifying as Asian or Asian American (25.3%). Respondents were mostly connected to the community as someone who didn't live or work in the Bitter Lake neighborhood, but was a frequent visitor (45.6% of respondents selected this choice) or someone who lived in the Bitter Lake neighborhood and could walk or bike to the park (37.6% of respondents selected this choice).

Appendices

Appendix A: Focus Group Summary Memo

Memorandum

To: Kevin Bergsrud, Project Planner, Seattle Parks and Recreation
Aaron Luoma, Project Consultant, HBB
Lael Alderman, Project Consultant, Consor

From: Nancy Thai, Project Consultant, Consor

Date: October 26, 2023

Subject: Bitter Lake Reservoir Open Space Project - Focus Group Summary

In attendance: Sue Jensen (area resident), Kippy Irwin (area resident), Mike Schuler (area resident), Cynthia Etelamaki (Bitter Lake Community Center coordinator), Jon Clark (P-Patch volunteer), Kevin Bergsrud (SPR), Aaron Luoma (HBB), Lael Alderman (Conсор), and Nancy Thai (Conсор)

Facilitators: Aaron Luoma and Nancy Thai

Meeting summary:

The focus group was held on Thursday, October 26, 2023 from 3:00 – 4:00 p.m. at the Bitter Lake Community Center in the Family Room. The focus group provided an opportunity for community members to learn more about the project and to provide their perspectives, priorities, feedback, concerns, and ideas on the park and open space design.

Nancy Thai (Conсор) welcomed participants and shared a brief overview of the Bitter Lake Reservoir Open Space Project, led by Seattle Parks and Recreation, and its relationship to the Bitter Lake Reservoir Improvement Project, led by Seattle Public Utilities. Aaron Luoma (HBB) and Lael Alderman (Conсор) walked participants through a map of Bitter Lake Reservoir to point out different aspects of the project.

Participants shared their names and which community or group they represented. During introductions, one resident shared their concerns about safety and visibility along the western side of the reservoir (Fremont Ave N) and worsening road conditions along the northside of the reservoir (N 143rd St) due to a berm removal 13 years ago. The berm removal has undermined the concrete panels and potholes are deepening due to water seeping in.

Aaron facilitated a conversation on what participants felt was currently missing at the Bitter Lake Reservoir park and open space. Participants shared several thoughts:

- Not enough P-patch space
 - Where can we expand to?
 - Don't want to disturb the current patch
 - Would be nice to have edible plants demonstrations for the community
- Expand the playground
- Basketball court
- Accessible paths

- Need sitting benches
- More lighting
- Mountain bike paths
- Amphitheater
- Some level ground for informal play
- Plant more trees, to help with cooling
- A path or loop around the park that's protected
- A dog park
 - Perhaps on the west side to offer more activity on that side of the park for the residents along Fremont Ave N
 - Not welcomed idea by one resident who lives there because of the noise
 - Could consider a buffer between the dog park and residents
- A sound park
- Spray park
- Would like a restroom, but recognize it's costly and requires maintenance
- Parking
 - Maybe time-limited spots
- A sledding hill

When asked what made participants feel safe, they responded having open space where you could see far and keep an eye on children playing (e.g., Yesler Terrace Park), clean space, activity and people around, and overhead and pathway lighting. Additionally, participants asked the project team to take a look at storm water plants and trim those that are overgrown because they are blocking access to the park and to be mindful of mature plant heights so that trees do not shade out the P-Patch. A participant asked for more accessible P-Patch spots, especially for people who are older or using mobility devices.

In closing, the project team shared they would keep the participants informed of the next round of engagement (likely early 2024), that there was a public survey open until November 10, and thanked everyone for their time and insights. A participant asked if they could invite other interested people, particularly younger people and families, to the next focus group, and the project team enthusiastically encouraged them to please do so.

Appendix B: Open House Boards and Stick Dots

SITE ANALYSIS - CURRENT SITE

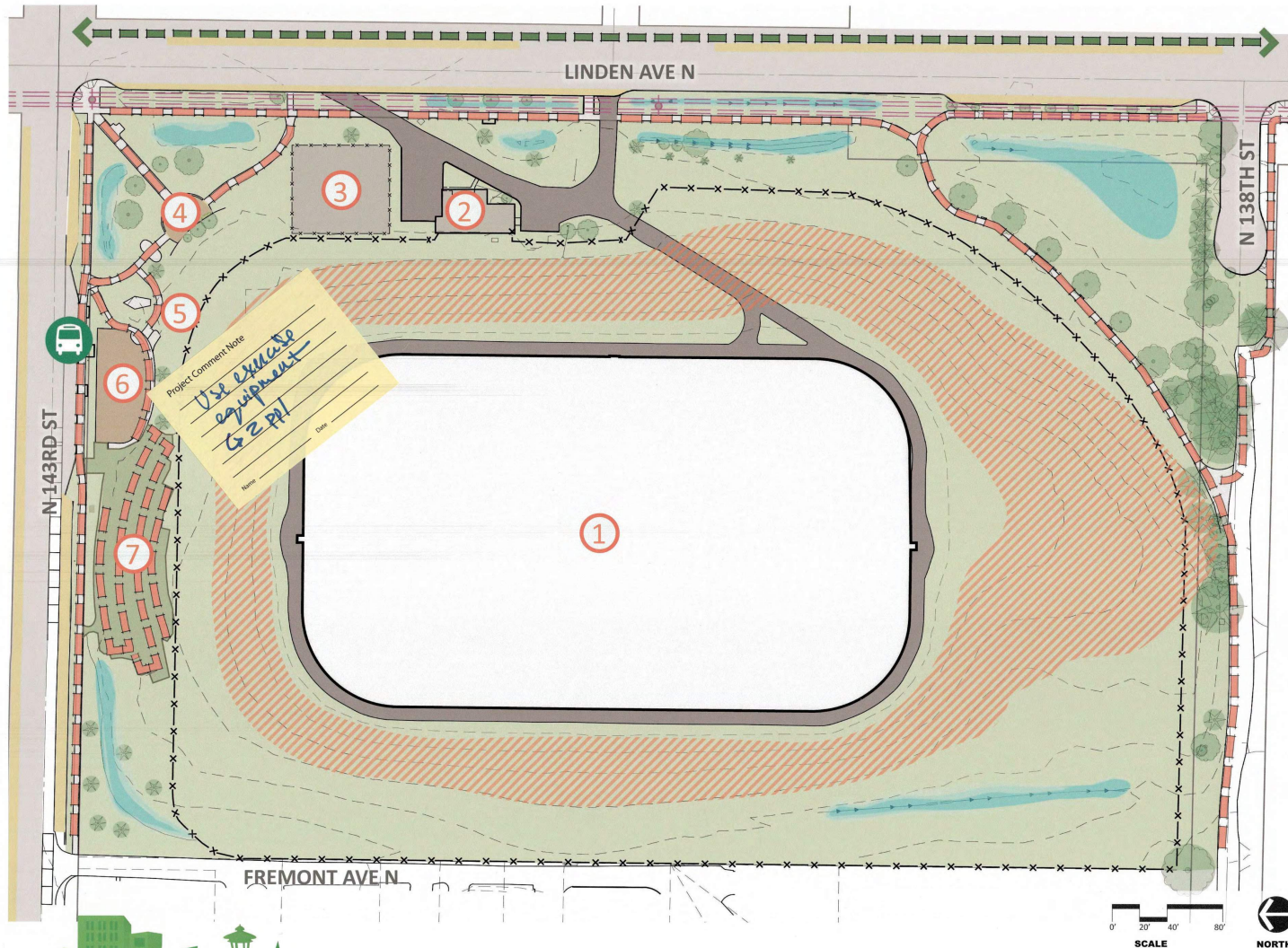

LEGEND

- ① Reservoir with floating cover
- ② Pump station
- ③ Maintenance storage area
- ④ Gathering Space
- ⑤ Public Art
- ⑥ Playground
- ⑦ P-Patch
- x-x- Security fence
- Stormwater facilities
- Maintenance access
- Public roads
- Parking
- Bus stop
- Bicycle path
- Pedestrian path
- High voltage power lines
- Steep slopes

Project Comment Note

OK loads? Now.
Please use a
low-carb, climate
friendly concrete

Name _____ Date _____

Project Comment Note

currently
lots of dog poop
along Linden
portion!

Name _____ Date _____

SITE ANALYSIS - CURRENT SITE



1



2



3

KEY MAP

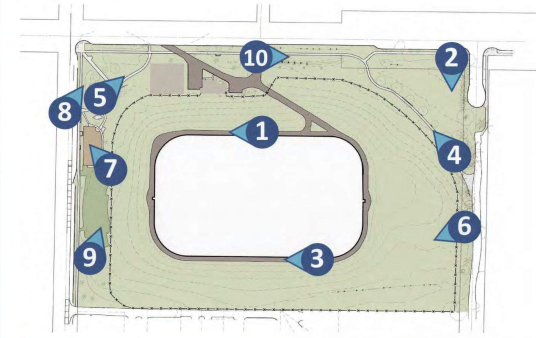

4



5



7

Project Comment Note

Needs more trash cans
lots of trash

Name _____ Date _____



8



9

Project Comment Note

How to keep it SAFE
for kids/families?
Design to deter encampments

Name _____ Date _____



6

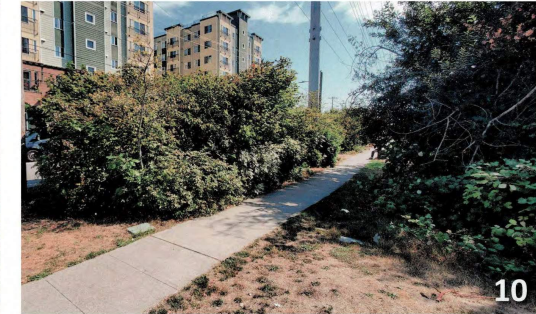

10

PROJECT TIMELINE

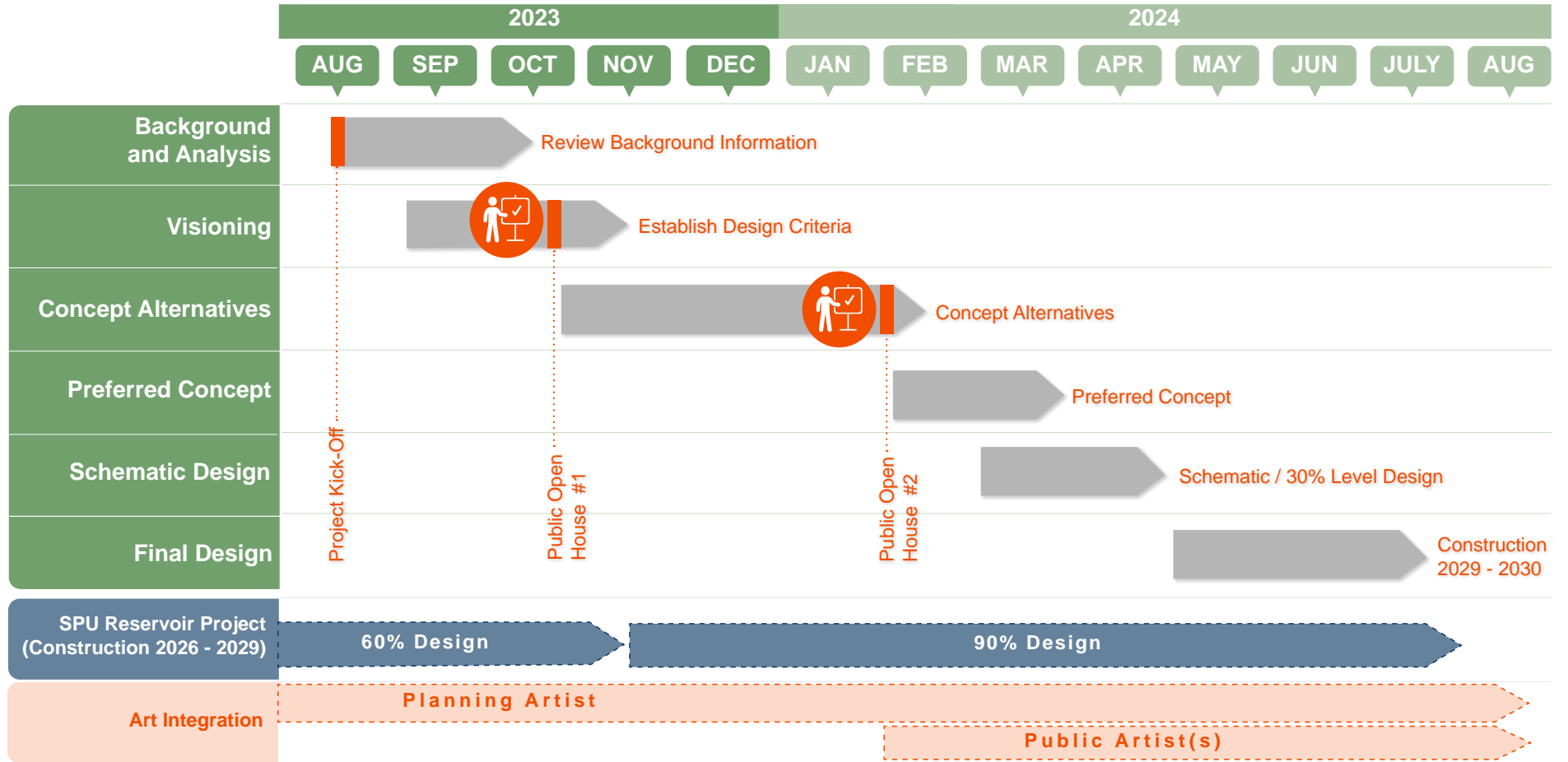

SITE ANALYSIS - NEW RESERVOIR

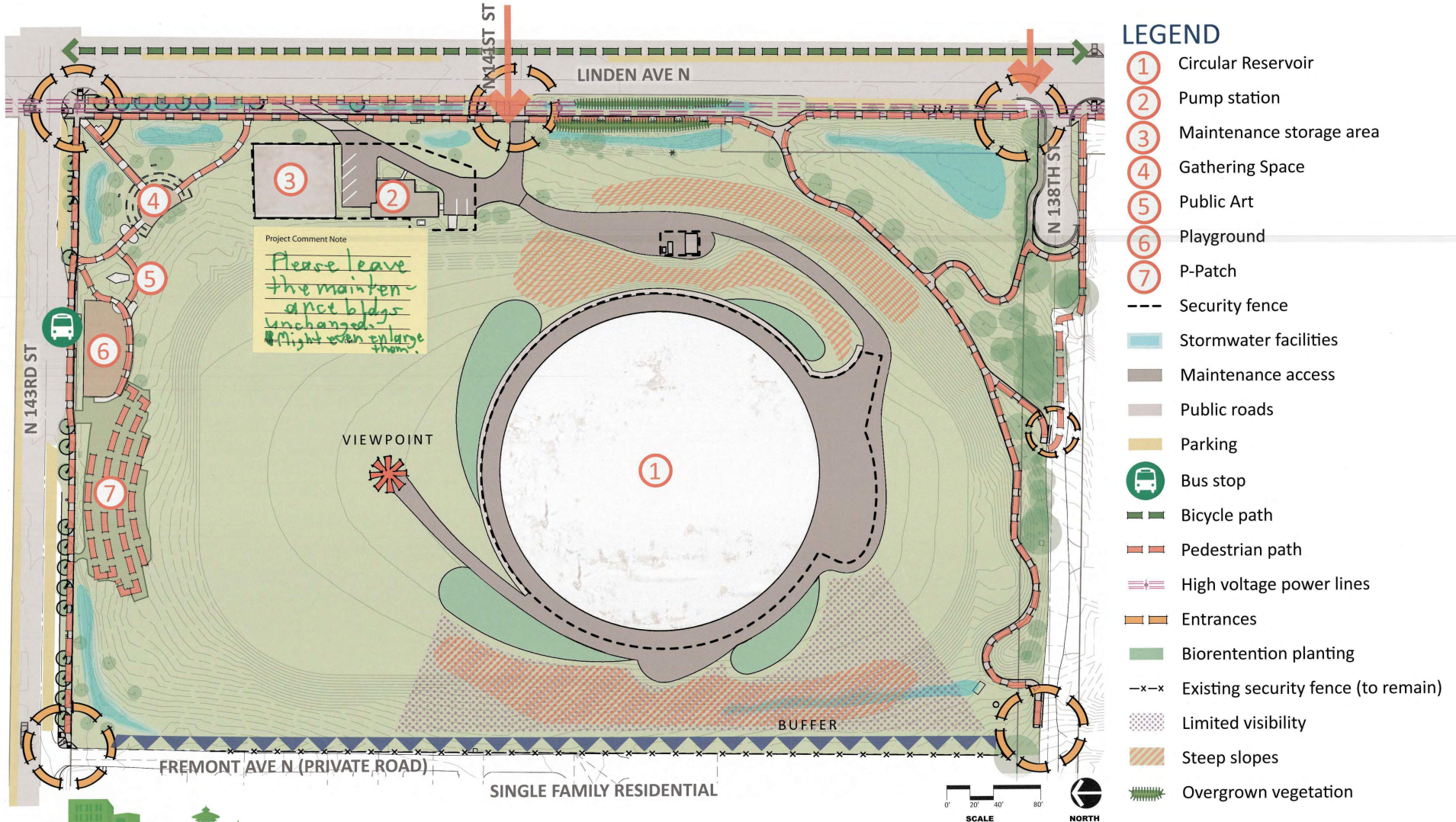

SITE ANALYSIS - NEW RESERVOIR

Section A

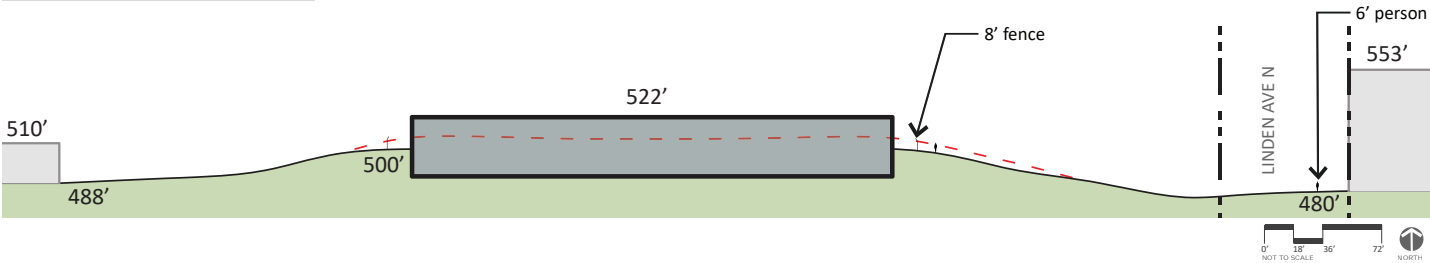

KEY MAP

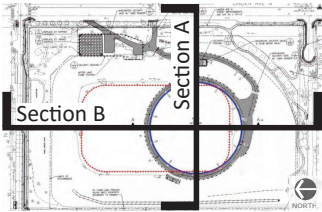

LEGEND

- Proposed grade at section line
- - - Ex grade at section line
- - - Ex right-of-way
- Concrete reservoir
- Building/House

Section B

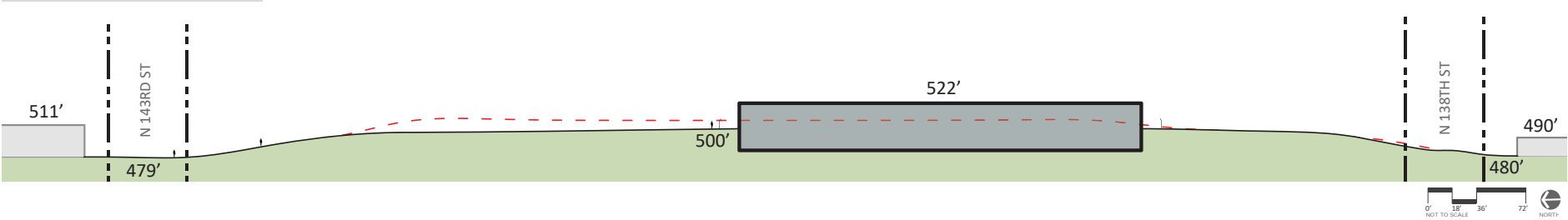

IMPROVEMENT OPPORTUNITIES

Place
a dot!

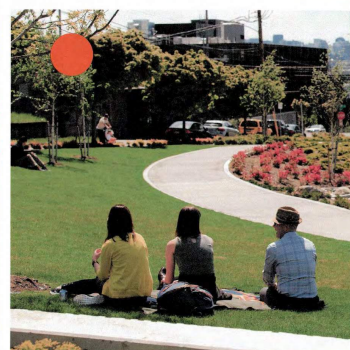
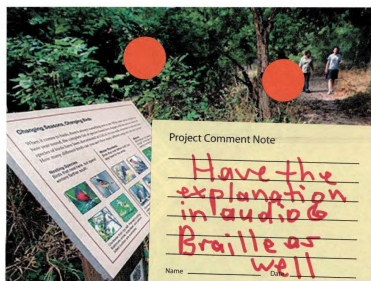
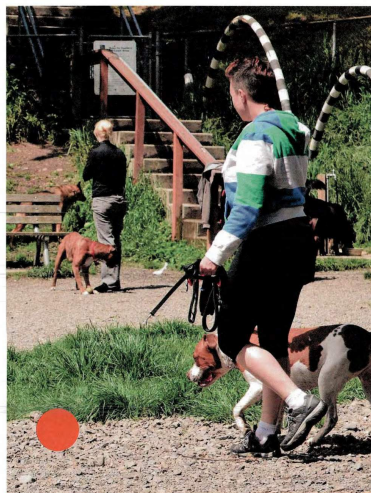

Don't forget to
take the survey!

Project Comment Note
Looped walking path
to walk four dog

 Name _____ Date _____

IMPROVEMENT OPPORTUNITIES

Place
a dot!

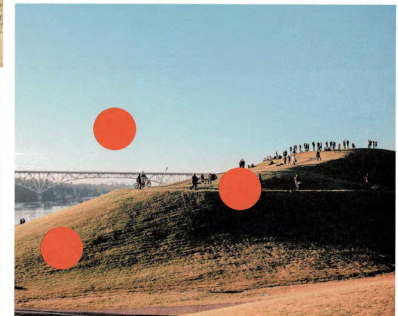
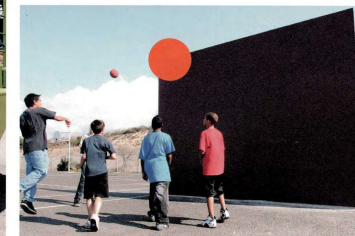
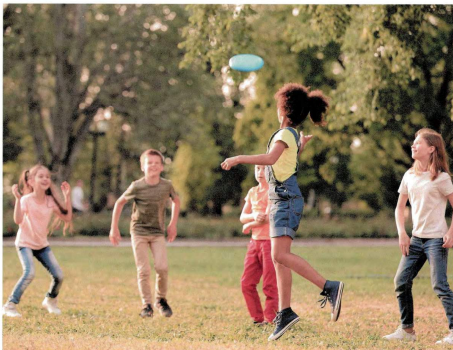
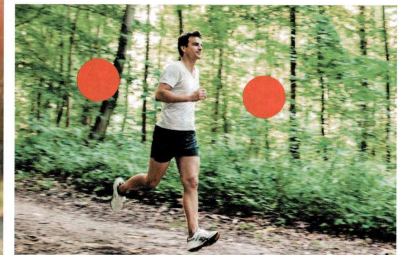
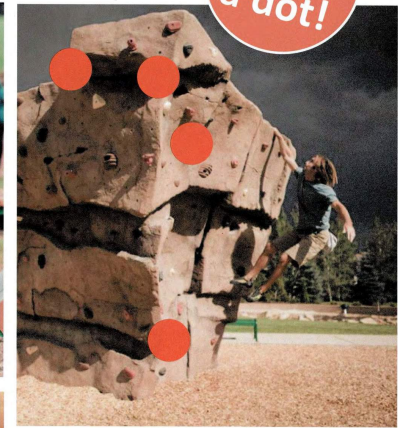

Don't forget to
take the survey!

IMPROVEMENT OPPORTUNITIES

Place
a dot!

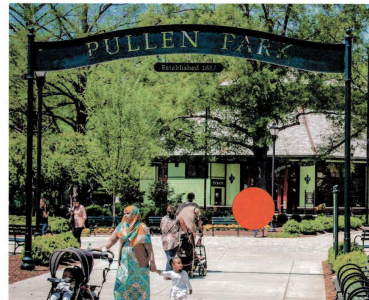
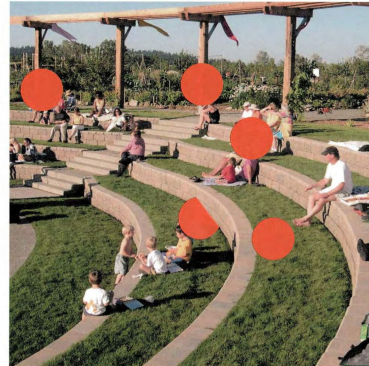
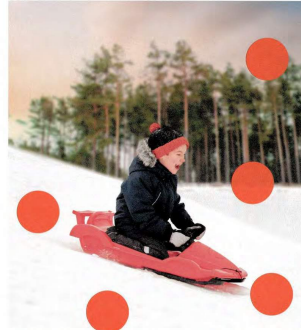

Don't forget to
take the survey!

Project Comment Note

Snuggled!
Pickleball

Name _____ Date _____

Bitter Lake Reservoir Open Space Project

COMMENT HERE!

Thanks for the open-house & for answering my questions. This is an educational idea. The answers gave me a new look at the existing park setup.

A decorative illustration at the bottom of the form shows a green grassy area with a blue river flowing through it. A dense line of dark green evergreen trees forms a backdrop. Several small figures of people are scattered across the grassy area, some standing and some sitting. The sky is light blue with a few small black birds flying. A yellow sun is visible in the top right corner of the form's background.

Appendix D: Survey Questions and Responses

Q1 How do you use the existing park? [Select all that apply]

Answered: 146 Skipped: 8

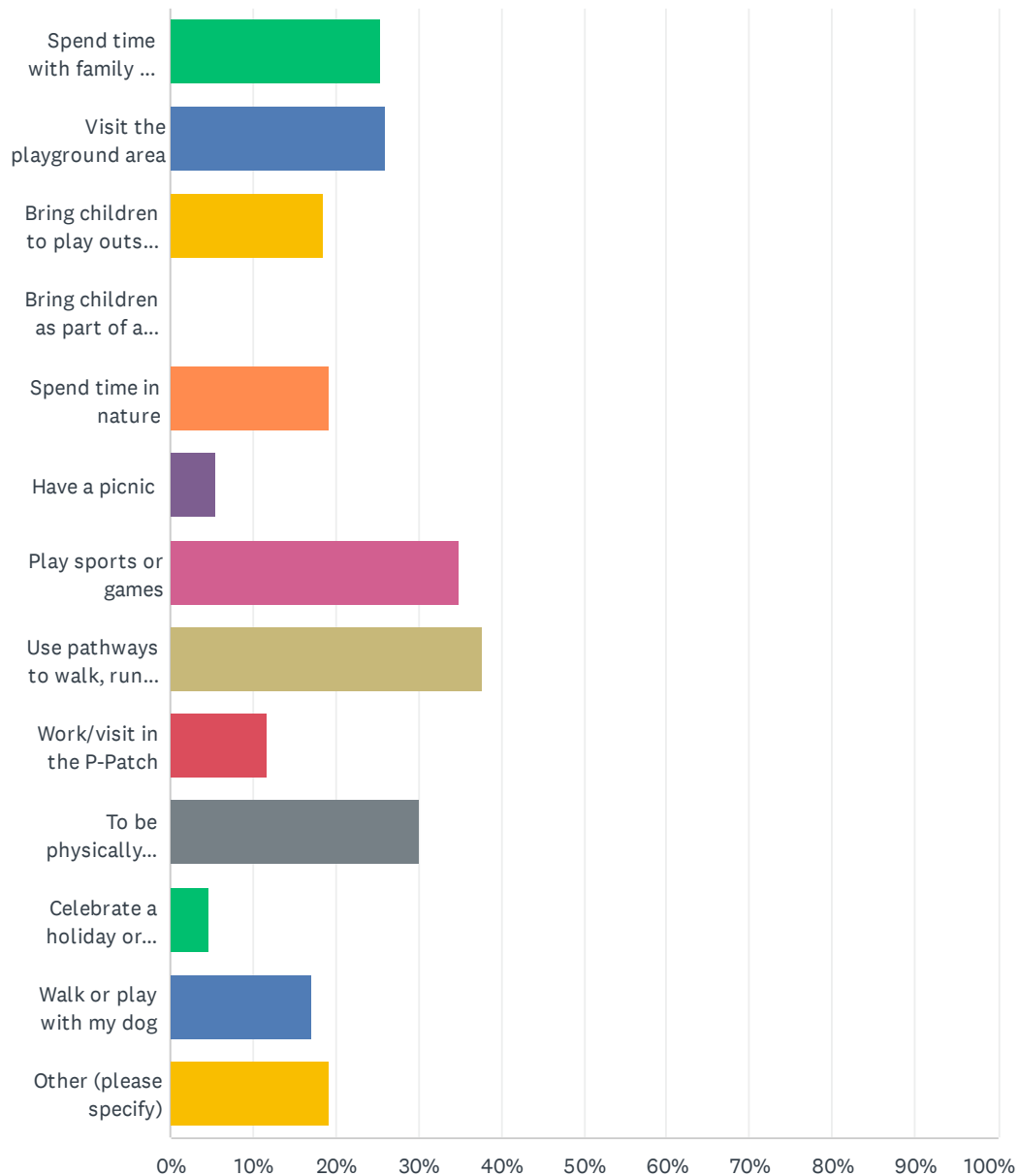

Bitter Lake Reservoir Park & Open Space Project

ANSWER CHOICES	RESPONSES	
Spend time with family and friends	25.34%	37
Visit the playground area	26.03%	38
Bring children to play outside of school time	18.49%	27
Bring children as part of a school/educational/programmatic outing	0.00%	0
Spend time in nature	19.18%	28
Have a picnic	5.48%	8
Play sports or games	34.93%	51
Use pathways to walk, run, bike, roll, etc.	37.67%	55
Work/visit in the P-Patch	11.64%	17
To be physically active and exercise	30.14%	44
Celebrate a holiday or event	4.79%	7
Walk or play with my dog	17.12%	25
Other (please specify)	19.18%	28
Total Respondents: 146		

#	OTHER (PLEASE SPECIFY)	DATE
1	Pickle ball	11/19/2023 12:51 PM
2	Wadle pool	11/19/2023 12:01 PM
3	We need more Sports courts like Sand volleyball courts and Pickleball courts, with lights and cover for dark and rainy winter! People get depressed by being not active as during summer. weatherproof sports courts are MUST!	11/18/2023 10:25 AM
4	Graffiti removal police/ crime reduction (who can onto a crime ridden park? and new streets instead please !	11/17/2023 9:16 PM
5	Pickleball play	11/15/2023 7:43 AM
6	pickleball court with lights please!	11/14/2023 2:26 PM
7	Pickleball	11/14/2023 2:26 PM
8	Pickleball	11/14/2023 12:05 PM
9	Play pickleball	11/14/2023 7:37 AM
10	Pickleball	11/14/2023 5:59 AM
11	play pickleball	11/13/2023 5:49 PM
12	Pickleball	11/13/2023 5:35 PM
13	Pickleball	11/13/2023 2:46 PM
14	Pickleball	11/13/2023 2:20 PM
15	I don't come here because there isn't any pickleball	11/13/2023 1:52 PM
16	Pickleball	11/13/2023 11:24 AM
17	Please put in 6 lighted pickleball courts....thank you!	11/13/2023 10:18 AM
18	Lighted pickle ball courts with partitions	11/13/2023 7:35 AM

Bitter Lake Reservoir Park & Open Space Project

19	Pickleball needs a presence after all its a Washington born sport and the fastest growing for the health and mental activity pickleball serves all best	11/13/2023 7:26 AM
20	Pickleball courts dedicated	11/12/2023 11:41 PM
21	Pickleball	11/12/2023 10:53 PM
22	Play pickleball on lighted courts	11/12/2023 10:14 PM
23	Pickleball courts please!	11/12/2023 8:46 PM
24	I use the now restricted area at the west edge of lake that is fenced off as a dog park. It's ideal because instead of gravel and mud, it's grassy and expansive allowing them to run. Few parks are like this. Most are gravel and mud pits.	11/8/2023 4:37 PM
25	Stop for a rest, water and bathroom break while bicycling.	11/8/2023 4:04 PM
26	I don't. No trees. No place to walk.	11/7/2023 8:56 PM
27	Tan	10/30/2023 5:59 PM
28	I honestly just walk around the perimeter of the park because it doesn't feel like there is enough space to hang out on the grass.	10/28/2023 1:49 PM

Q2 Which recreation features and activities do you most want to see included in the existing and expanded park? Rate the options from scale 1 – 5 (1 being no interest at all, with 5 being very high interest).

Answered: 149 Skipped: 5

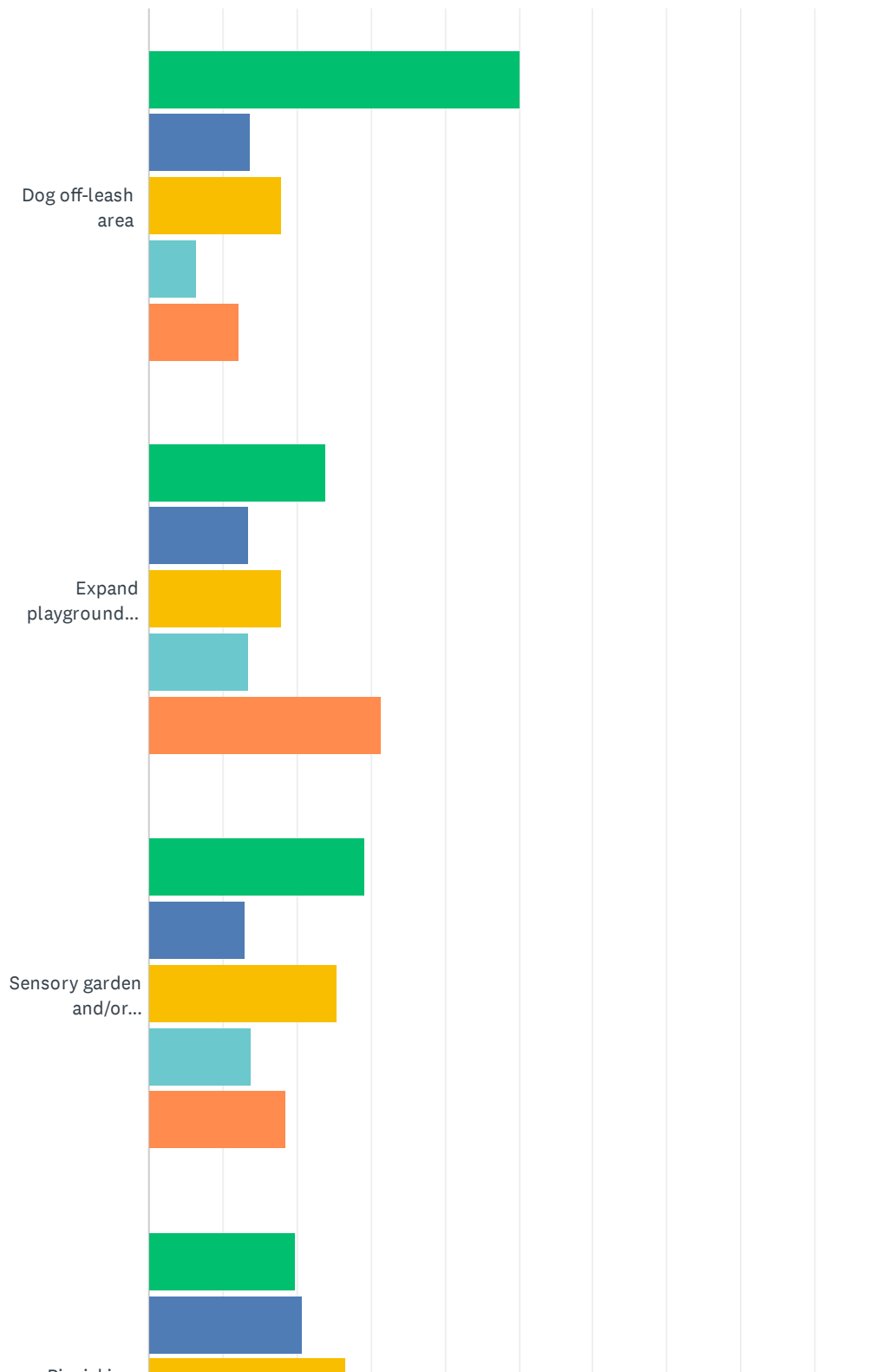

Bitter Lake Reservoir Park & Open Space Project

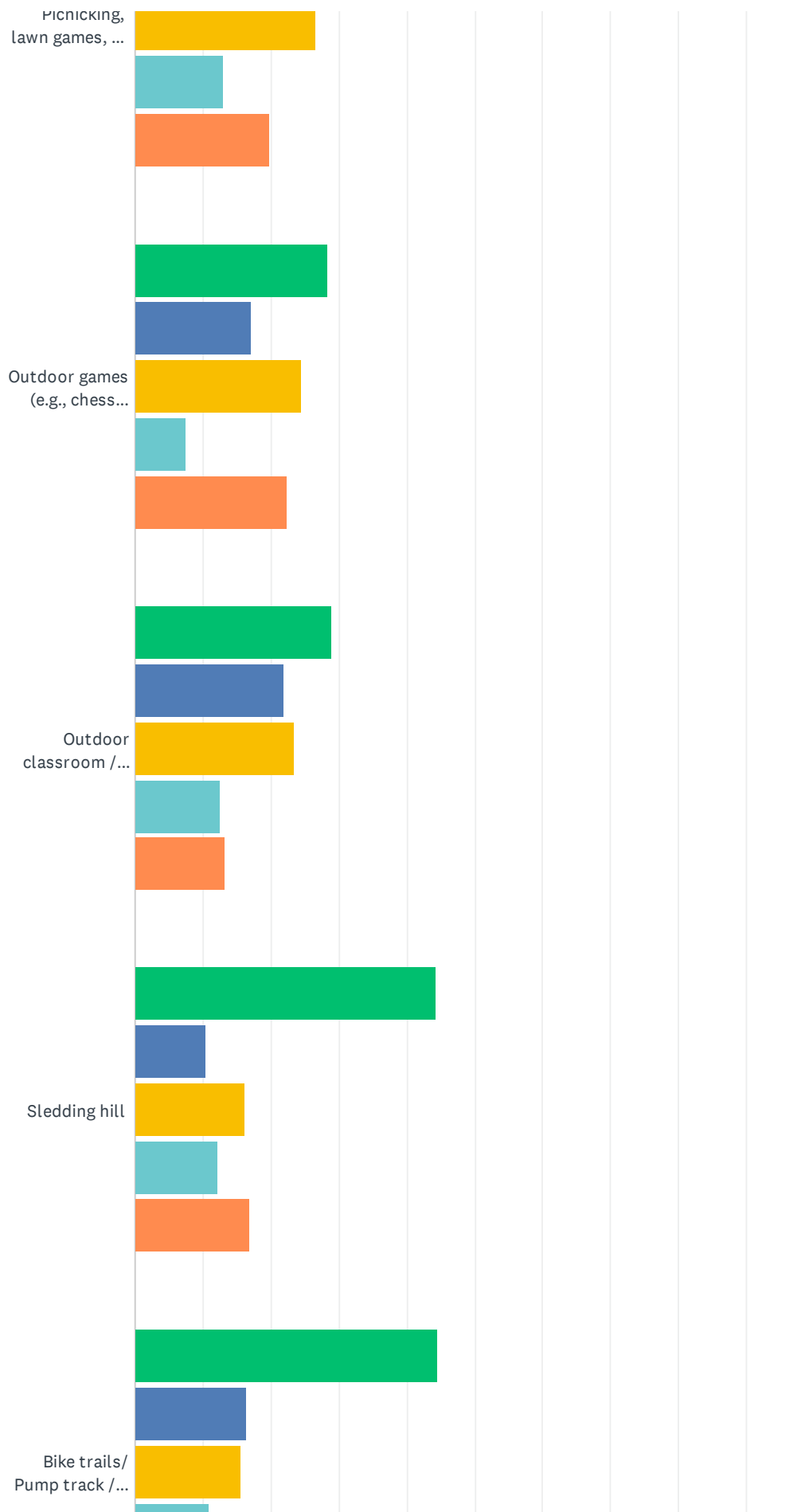

Bitter Lake Reservoir Park & Open Space Project

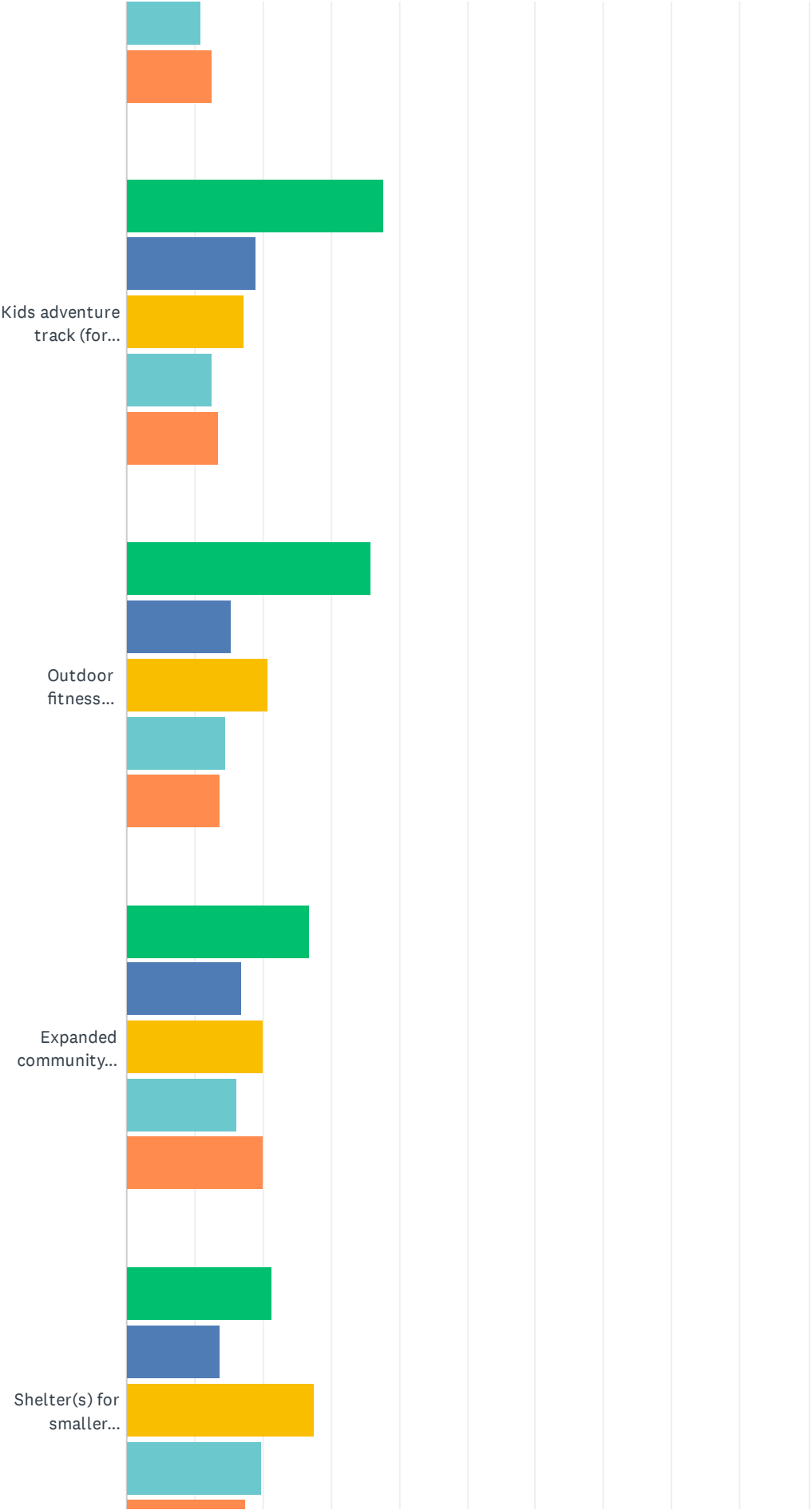

Bitter Lake Reservoir Park & Open Space Project

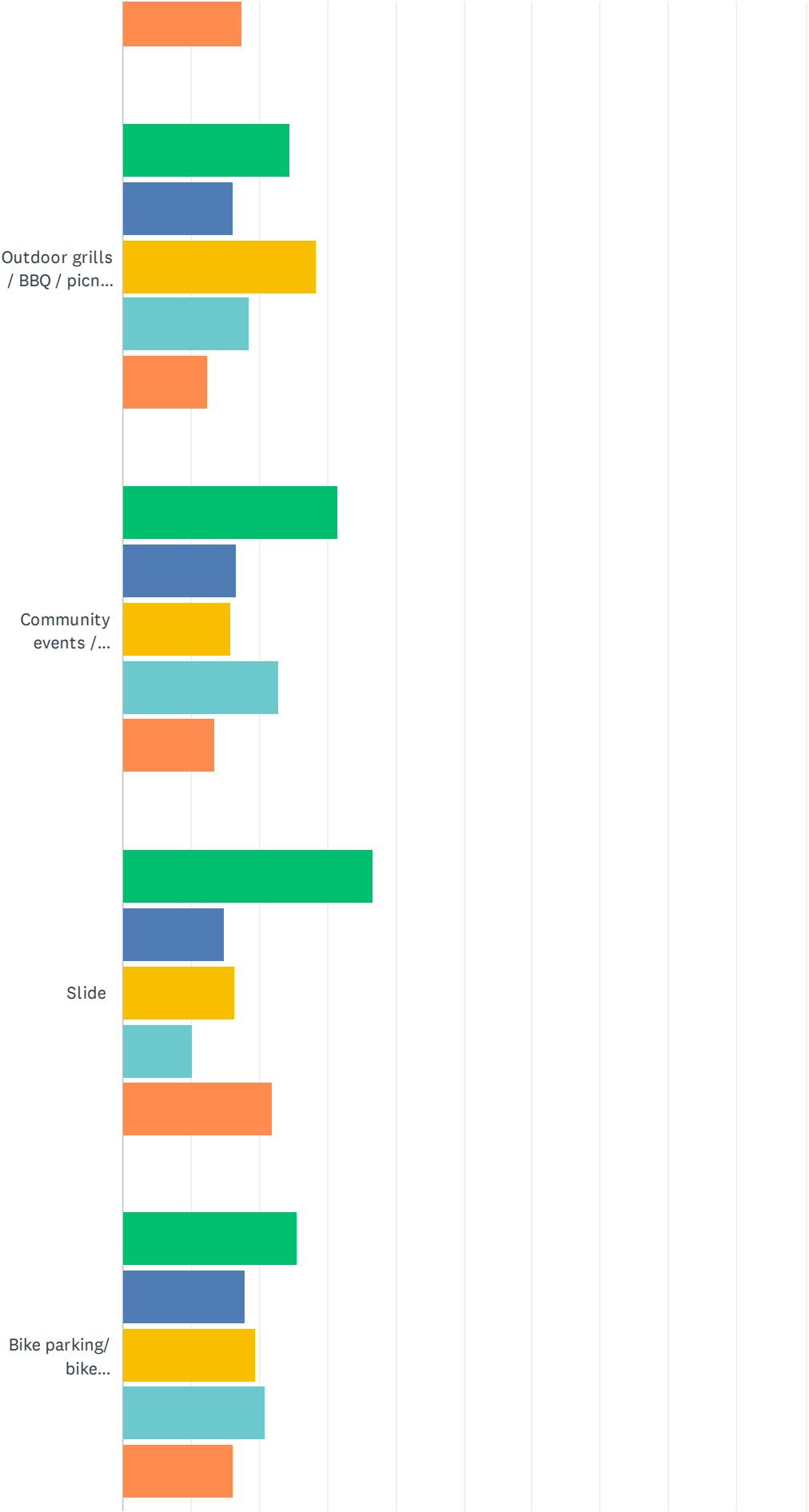

Bitter Lake Reservoir Park & Open Space Project

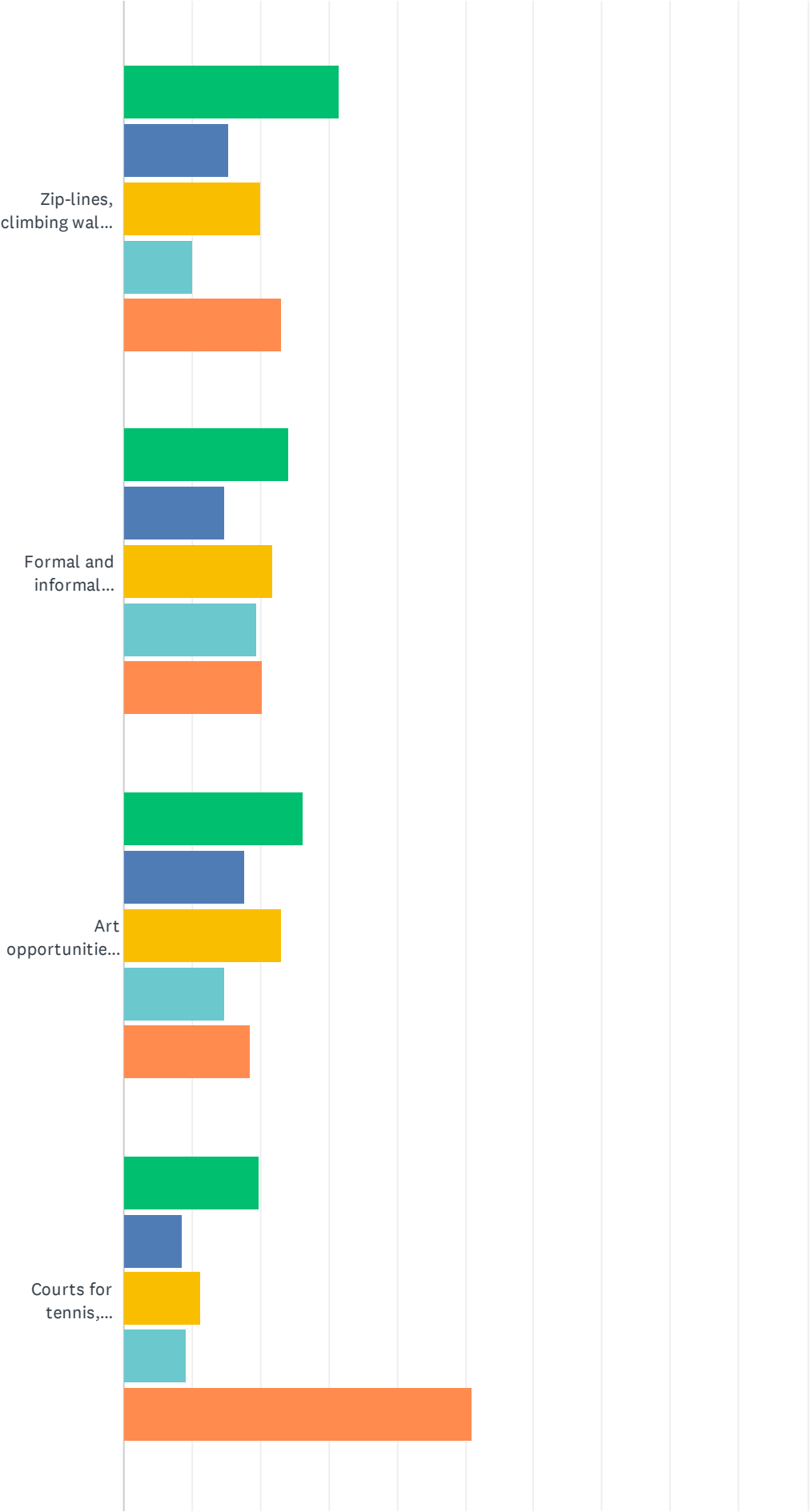

Bitter Lake Reservoir Park & Open Space Project

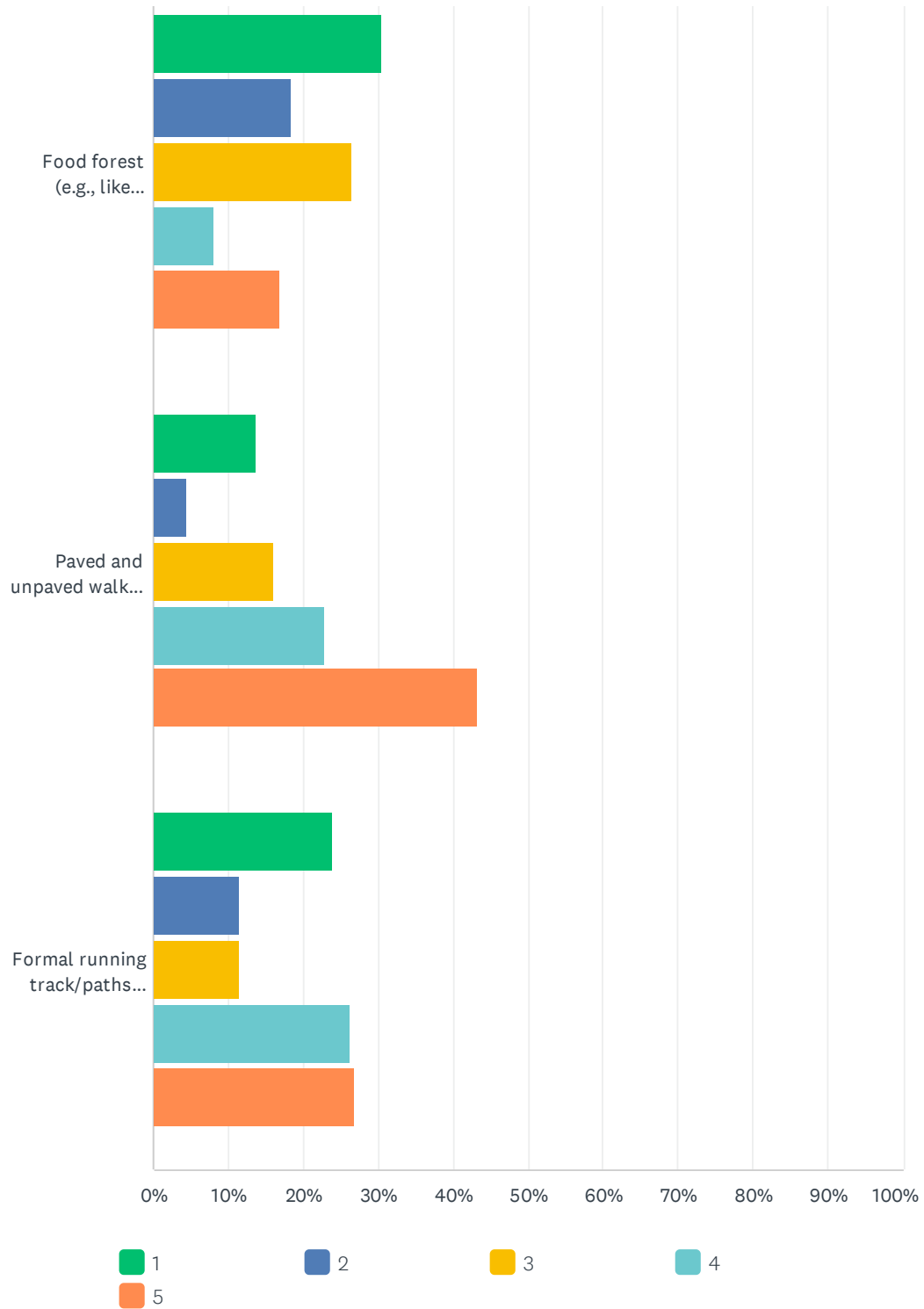

Bitter Lake Reservoir Park & Open Space Project

	1	2	3	4	5	TOTAL	WEIGHTED AVERAGE
Dog off-leash area	50.00% 70	13.57% 19	17.86% 25	6.43% 9	12.14% 17	140	2.17
Expand playground (nature-based, traditional, etc.)	23.88% 32	13.43% 18	17.91% 24	13.43% 18	31.34% 42	134	3.15
Sensory garden and/or children's garden	29.23% 38	13.08% 17	25.38% 33	13.85% 18	18.46% 24	130	2.79
Picnicking, lawn games, and other informal activities	19.85% 26	20.61% 27	26.72% 35	12.98% 17	19.85% 26	131	2.92
Outdoor games (e.g., chess board, ping-pong table)	28.36% 38	17.16% 23	24.63% 33	7.46% 10	22.39% 30	134	2.78
Outdoor classroom / learning opportunities / interpretive signage	28.91% 37	21.88% 28	23.44% 30	12.50% 16	13.28% 17	128	2.59
Sledding hill	44.35% 55	10.48% 13	16.13% 20	12.10% 15	16.94% 21	124	2.47
Bike trails/ Pump track / BMX track	44.53% 57	16.41% 21	15.63% 20	10.94% 14	12.50% 16	128	2.30
Kids adventure track (for younger kids)	37.80% 48	18.90% 24	17.32% 22	12.60% 16	13.39% 17	127	2.45
Outdoor fitness equipment	35.88% 47	15.27% 20	20.61% 27	14.50% 19	13.74% 18	131	2.55
Expanded community garden / P-Patch	26.92% 35	16.92% 22	20.00% 26	16.15% 21	20.00% 26	130	2.85
Shelter(s) for smaller community gatherings	21.37% 28	13.74% 18	27.48% 36	19.85% 26	17.56% 23	131	2.98
Outdoor grills / BBQ / picnic tables	24.62% 32	16.15% 21	28.46% 37	18.46% 24	12.31% 16	130	2.78
Community events / amphitheater	31.50% 40	16.54% 21	15.75% 20	22.83% 29	13.39% 17	127	2.70
Slide	36.72% 47	14.84% 19	16.41% 21	10.16% 13	21.88% 28	128	2.66
Bike parking/ bike maintenance / hydration station	25.58% 33	17.83% 23	19.38% 25	20.93% 27	16.28% 21	129	2.84
Zip-lines, climbing walls, ropes courses, etc. (for all ages)	31.54% 41	15.38% 20	20.00% 26	10.00% 13	23.08% 30	130	2.78
Formal and informal seating	24.03% 31	14.73% 19	21.71% 28	19.38% 25	20.16% 26	129	2.97
Art opportunities / art integration	26.15% 34	17.69% 23	23.08% 30	14.62% 19	18.46% 24	130	2.82
Courts for tennis, basketball, volleyball, etc.	19.86% 28	8.51% 12	11.35% 16	9.22% 13	51.06% 72	141	3.63
Food forest (e.g., like Beacon Hill)	30.40% 38	18.40% 23	26.40% 33	8.00% 10	16.80% 21	125	2.62
Paved and unpaved walking paths / trails	13.64% 18	4.55% 6	15.91% 21	22.73% 30	43.18% 57	132	3.77
Formal running track/paths (e.g., ¼ mile or ½ mile loops around reservoir)	23.85% 31	11.54% 15	11.54% 15	26.15% 34	26.92% 35	130	3.21

Bitter Lake Reservoir Park & Open Space Project

#	OTHER (PLEASE SPECIFY)	DATE
1	Usable quality Sand volleyball courts like Juanita and Willis Tucker park. With Night lights same as tennis courts or soccer field. Not fair no lights for volleyball courts in Seattle area!	11/18/2023 10:25 AM
2	Safety is #1 or it's all wasted money. WillBBQ grills encourage encampments ?	11/17/2023 9:16 PM
3	Pickleball, why is it not even listed?! Hello!!	11/17/2023 10:13 AM
4	Pickleball courts	11/15/2023 9:57 PM
5	Dedicated pickleball courts	11/15/2023 9:39 PM
6	Pickleball courts	11/15/2023 6:19 PM
7	Pickleball Courts!!!	11/15/2023 2:22 PM
8	PLEASE provide DEDICATED pickleball courts with permanent nets and enough space behind and beside court lines to use properly. 12 courts would be awesome but even six - 8 quality courts, with lights, would be nice. Covers over a couple would be awesome to provide year round outdoor play	11/15/2023 11:41 AM
9	I would love to see a dozen dedicated pickleball courts with lights	11/15/2023 9:40 AM
10	A dozen pickleball courts with lights	11/15/2023 8:07 AM
11	Pickleball Courts	11/15/2023 7:43 AM
12	lighted pickleball courts	11/15/2023 7:43 AM
13	Designated Pickleball courts	11/15/2023 6:59 AM
14	splash park!	11/14/2023 8:34 PM
15	features to maintain Park safety, splash park, fence to prevent young children from running into the street	11/14/2023 3:32 PM
16	Splash pad!	11/14/2023 3:27 PM
17	pickleball court with lights.	11/14/2023 2:26 PM
18	Pickleball courts	11/14/2023 2:26 PM
19	SPLASH PARK, accessible playground equipment	11/14/2023 2:13 PM
20	Dedicated outdoor pickleball with lights for night playing	11/14/2023 12:36 PM
21	Pickleball courts	11/14/2023 12:05 PM
22	Courts for Pickleball with Lights	11/14/2023 7:37 AM
23	Dedicated Pickleball courts	11/14/2023 6:49 AM
24	Pickleball	11/14/2023 5:59 AM
25	Pickleball courts	11/13/2023 8:32 PM
26	Dedicated pickleball courts with lights	11/13/2023 8:23 PM
27	Pickleball courts	11/13/2023 8:17 PM
28	Futsal/all weather soccer court!	11/13/2023 7:02 PM
29	12 or more dedicated, lighted, pickleball courts!	11/13/2023 5:49 PM
30	Pickleball courts	11/13/2023 5:21 PM
31	Dedicated pickleball courts with lights	11/13/2023 2:46 PM
32	Dedicated pickleball courts (not shared with tennis)	11/13/2023 2:35 PM
33	Covered, dedicated pickleball courts	11/13/2023 2:20 PM
34	Dedicated outdoor pickleball courts with lights	11/13/2023 1:52 PM

Bitter Lake Reservoir Park & Open Space Project

35	Pickleball courts please	11/13/2023 10:18 AM
36	Dedicated outdoor pickleball courts with lights	11/13/2023 8:50 AM
37	Perfect space for 12 lighted pickleball courts	11/13/2023 8:38 AM
38	Pickleball courts	11/13/2023 7:51 AM
39	Pickleball ball courts lighted	11/13/2023 7:35 AM
40	16 dedicated and lit pickleball courts	11/13/2023 7:28 AM
41	Pickleball	11/13/2023 7:26 AM
42	dedicated pickleball!! ideally covered and definitely with lights. pretty, pretty please	11/13/2023 7:19 AM
43	12 dedicated pickleball courts with lights	11/13/2023 7:18 AM
44	Dedicated Pickleball corts	11/13/2023 5:04 AM
45	Pickleball courts dedicated many	11/12/2023 11:41 PM
46	8 Dedicated pickleball courts	11/12/2023 11:20 PM
47	Pickleball courts	11/12/2023 10:53 PM
48	6 lighted pickleball courts	11/12/2023 10:14 PM
49	Dedicated Pickleball courts	11/12/2023 9:58 PM
50	Pickleball	11/12/2023 9:46 PM
51	12 dedicated pickleball courts	11/12/2023 9:25 PM
52	Large 12-24 court Pickleball complex - covered with lights	11/12/2023 8:58 PM
53	Pickleball courts	11/12/2023 8:52 PM
54	Pickleball courts please!	11/12/2023 8:46 PM
55	Pickleball courts	11/12/2023 8:28 PM
56	12 dedicated pickleball courts with lights	11/12/2023 8:23 PM
57	A dozen dedicated outdoor pickleball courts with lights.	11/12/2023 7:49 PM
58	The expansion of the P-patch cool be communal food forest. Super hard to get local low income neighbors to manage otherwise. How well is the p-patch expanding how well does the Beacon food forest self manage. Formal additions will keep people doing an active. Informal means one group might overtake the open space. Trying to reforestation will take decades but let's try to teach the kids and neighbors about open space!!	11/12/2023 9:24 AM
59	Wading pool	11/10/2023 9:36 AM
60	More trees and wooded walkways	11/10/2023 6:04 AM
61	I live on the private drive, west of the water reservoir, so something quit, as it is now!	11/9/2023 12:12 PM
62	A more natural dog off leash area that isn't all mud gravel and dirt with grass, trees and vegetation instead.	11/8/2023 4:37 PM
63	Allow track/path to be used by bicyclists	11/8/2023 4:04 PM
64	How about adding some lawn bowling or Bocce Ball courts?	11/8/2023 1:53 PM
65	informal lawn play areas. Small amphitheater and stage	11/3/2023 4:29 PM
66	SKATE PARK!! Or flat spot to quad skate like the White Center Bicycle Playground.	11/2/2023 11:38 AM
67	Tanning area	10/30/2023 5:59 PM
68	Top priority: space to lay out a blanket and relax on grass	10/28/2023 1:49 PM

Q3 When you think about all the best parks you have visited, what makes them your favorite or why do they stand out to you? What makes them feel safe? Feel free to add the name or location of some of your favorite places.

Answered: 107 Skipped: 47

#	RESPONSES	DATE
1	good lighting at nights and lots of spaces to sit after a game. Being able to use the game facilities rain or shine	11/20/2023 6:58 AM
2	Parks without homeless camps are safest.	11/19/2023 10:54 PM
3	My favorite park is Maple Leaf reservoir park. i love it because it has nice paved walking/running trails, great maintenance and clean. I also live that there are nearby businesses to support (examples: cloud city coffee and macrina bakery).	11/19/2023 3:07 PM
4	Children park	11/19/2023 12:01 PM
5	My favorite parks have beach volleyball, good lighting and clean.	11/18/2023 3:01 PM
6	Apt parking	11/18/2023 1:01 PM
7	1. has enough parking and easy access. 2. quality (well maintained) of sports courts. I.e. MaryMoor, Hartman park, Perrigo park in Redmond, Juanita park, Google Corridor park in kirkland, Willis Tucker in Snohomish. 3. Night lights in the park and parking lot.	11/18/2023 10:25 AM
8	Magnuson off leash seems safe and populated well lit. There aren't enough artificial turf fields for kids in Seattle schools to use for soccer just mud..	11/17/2023 9:16 PM
9	Clean, something artistic that is different or interesting like the salmon slide, nice view or landscaping	11/17/2023 8:33 PM
10	1-Safety first- comfortable bringing my children there. Not worrying up them picking up needles and being yelled at if an individual is having a mental health episode. 2- beauty and recreation	11/17/2023 6:03 PM
11	Maple Leaf feels very safe and similar to what could be done at Bitterlake	11/17/2023 12:27 PM
12	When they are clear, well maintained, and are not filled with drug use and paraphernalia	11/17/2023 11:16 AM
13	Trails, shelters, dog off leash	11/17/2023 10:13 AM
14	Clean, well maintained	11/17/2023 8:33 AM
15	Greenery	11/16/2023 3:30 PM
16	I love taking my kids to the park and when is clean and here is trash cans and people cleaning after their dogs is the best feeling.	11/16/2023 3:06 PM
17	Fenced in playground, clean, easy parking, good lighting for winter.	11/16/2023 1:31 PM
18	Gas Works Park - interesting historical structures, nice path system, great views. Green Lake - cycling/walking path, views of lake. Discovery Park - lots of walking paths.	11/15/2023 9:57 PM
19	Trail around the lake @Green lake	11/15/2023 9:39 PM
20	Lights. People around Good visibility from the street	11/15/2023 8:51 PM
21	Parks have a variety of activities offered, tennis and pickleball.	11/15/2023 6:34 PM
22	My kids love Battle Point Park on Bainbridge Island. The play equipment is unique and feels special, rather than the standard 'kit' that is starting to feel ubiquitous around the city. They also planted beautiful colorful flowers in amongst the playground that bloom all summer. I'd love to see big drought tolerant shade trees, so we can use the park during the hottest days of	11/15/2023 12:41 PM

Bitter Lake Reservoir Park & Open Space Project

summer. The Inspiration Playground in Bellevue is also fun and feels safe and clean, though my 5 and 8 yr. old prefer Battle Point. The sensory garden in the back corner of the Woodland Park Zoo's Rose Garden is beautiful! Can there please be an area that is a well-tended garden? Maybe volunteers could oversee the maintenance? I would sign-up to weed, deadhead, mulch, etc. It's so therapeutic and community-building. You don't have to speak the same language to garden together, and we need this now more than ever. It's the perfect location to bring many different people together. This is my biggest ask for this new space.

23	I like parks that offer cleanliness, bathrooms, and enough parking for the activities provided. Good lighting, cameras in parking lots, and designated areas for certain activities are awesome. The south Bellevue park for pickleball is awesome but needs lights - it provides some shade for summertime play. Parking seems to be an issue at a lot of parks but Kirkland has some parks with several parking areas making it nice to park nearest your activity.	11/15/2023 11:41 AM
24	Lighting, garage cans, clean, lots of people makes it feel safe, quality playground	11/15/2023 9:41 AM
25	Greenlake offers 8 pickleball courts, but they are still way overcrowded.	11/15/2023 9:40 AM
26	Pickleball Courts	11/15/2023 7:43 AM
27	Maple leaf reservoir park has nice walking path and playground, shelters.	11/14/2023 10:09 PM
28	I love a mix or natural areas and play structures for our family. North Acres is a great example of this with two playgrounds, a splash park, and beautiful, meandering trails.	11/14/2023 8:34 PM
29	They are well used, there are different kinds of places within the park that you can use differently, feeling of getting to experience nature and plants, easy to walk around in. Love Jefferson Park and Seward Park.	11/14/2023 6:30 PM
30	Spray parks and other places with unique offerings are great.	11/14/2023 5:44 PM
31	parks that have creative and colorful artwork as backdrops to modern and safe playground. parks that are well-lit, free of litter, ample parking, frequently visited by young families. parks that host activities such as group soccer and basketball	11/14/2023 3:32 PM
32	Safe for SMALL children-low to the ground. Loyal heights	11/14/2023 3:27 PM
33	Parks feel safe when there are lots of people gathering there to do things they enjoy. The parks in Beijing are full of people playing chess and ping pong, taking dance classes, practicing Tai chi, bird watching, picnicking, playing with their kids or just going for a walk. The parks feel safe even at 11:00 pm because so many people enjoy gathering there to have fun with their families and neighbors.	11/14/2023 3:08 PM
34	Thornton Sullivan in Everett - lots of structures to play for all ages, walking paths, shaded area to picnic. Hazel Miller in Mountlake Terrace - fenced play area, lots of swings. Accessible.	11/14/2023 2:50 PM
35	bellbank park arizona	11/14/2023 2:26 PM
36	Many activity based opportunities	11/14/2023 2:26 PM
37	Jefferson Park in Beacon Hill is one of our favorites! So many things to do, we spent so much time there. Love the interactive kids activities, and spaces for gathering	11/14/2023 2:13 PM
38	Adding well lit pickleball courts is a great addition to any new/renovated public park.	11/14/2023 12:49 PM
39	I like the Marymor dog park. Even though I do not have a dog, I feel safe walking around there and enjoying it. I like the Rainier beach Seattle pickleball courts because you can play at night with outdoor lights	11/14/2023 12:36 PM
40	Greenlake-I love the variety of open green space, walking trail, pickleball courts, lake...	11/14/2023 7:37 AM
41	Seward park, Jefferson park. People enjoying outdoors	11/14/2023 6:49 AM
42	Greenlake, Laurelhurst	11/14/2023 5:59 AM
43	Game areas like pickleball. Nature areas. Well lit. Restrooms. Miller has great pickleball courts (but too busy), Mt Baker has pickleball courts and nice nature and accessible portable restrooms	11/13/2023 9:20 PM
44	Mixed use. Highly utilized. Serve the greatest needs. Bob Kildee Psrk Camarillo, CA Sawyer Point Cincinnati Demuth Park Palm Dprings	11/13/2023 8:23 PM

Bitter Lake Reservoir Park & Open Space Project

45	Tall trees, nature, inviting tennis/pickleball courts, community center events	11/13/2023 8:17 PM
46	They all include dedicated, lighted, pickleball courts!	11/13/2023 5:49 PM
47	Parking, lighting, security, bathrooms, no homeless around	11/13/2023 5:35 PM
48	Clean open air	11/13/2023 2:53 PM
49	We go to bitterlake regularly, daily even for pickleball because of availability and lighting for night time play	11/13/2023 2:46 PM
50	I love Mt Baker and Carkeek parks and Miller. MtB has nature surrounding the courts and children and dog play areas; Carkeek has a few trails and beach access -- integrates nature (but no courts). Miller has wonderful courts (but few, and shared with tennis) and on a bust corner. ALL need 24/hr bathroom access -- like Rainier Beach	11/13/2023 2:35 PM
51	Clean restrooms. Well, lighted trails, courts and fields.	11/13/2023 2:20 PM
52	Pickleball Complexe at Sunset Regional Park in Las Vagas, NV	11/13/2023 1:52 PM
53	Gilman, Shoreline, Miller, Beacon Hill. Great pickleball courts....lovely parks...	11/13/2023 10:18 AM
54	Pioneer Park Pickleball Courts, Walla Walla, WA	11/13/2023 8:50 AM
55	Pickleball	11/13/2023 8:38 AM
56	Lighted, trails well maintained, people around and lots of activity, cleared of homeless	11/13/2023 8:38 AM
57	Lights at night! Sport activities, food trucks, adequate restrooms with lockout	11/13/2023 7:35 AM
58	East Greenlake pickleball Because it creates a safe eviorment	11/13/2023 7:26 AM
59	Blcakburn Pickleball facility in Mount Vernon	11/13/2023 7:19 AM
60	Dedicated pickleball courts and better yet with lights	11/13/2023 5:04 AM
61	No homeless or drug use. I love Greenlake and Magnuson Park. There are lots of walking paths, open space, multi use facilities like soccer fields, kite, Hill,, the bath house, dog parks, etc. It's a great place to meet your friends, go for walks and be inspired by the diversity of the people of Seattle.	11/12/2023 11:20 PM
62	Lights in area. No camping or overnight.	11/12/2023 10:53 PM
63	Miller has nice outdoor pickleball courts	11/12/2023 9:58 PM
64	good maintenance and periodic security patrol	11/12/2023 9:46 PM
65	Green lake / lower woodland variety of activities , walks , pickleball, tennis, sports field s boating	11/12/2023 9:25 PM
66	Good sight lines, well lit, views, nice activities	11/12/2023 8:52 PM
67	Green Lake park	11/12/2023 8:46 PM
68	Volunteer Park - Trees, seating, amphitheater Lincoln Park - Trees, seating, paths, lots of distinct areas	11/12/2023 8:28 PM
69	Little valley St. George Utah. Lighted pickleball courts, places to sit and watch, shade, water, restrooms	11/12/2023 8:23 PM
70	Pickleball at Sawyer Point, Cincinnati.	11/12/2023 7:49 PM
71	Favorite... attempts at authenticity. Golden Gate park in SF has combined very "programmed" -rose and Dalia gardens.But also has volunteer let programs like AiDS memorial or mountain biking and fun foested paths. Pull together volunteer groups and let them plan it? Disc golf would be great. Such a bummer that only homeowners have access to Bitter lake! Let's connect all the open space! Not everyone's grandparents had a house out there! History matters! Access and learing about soil health, open space and natural areas matter. No grass (monoculture) please. Teach environmentalism to kids and immigrants to WA and US. Sledding hill is only fun for 1 out if 5 years... but was fun in 2019 (at the Center)... good luck.	11/12/2023 9:24 AM
72	Nature setting, away from road noise, nice paths for short walks, ability to use stroller, nice playground, wading pool for kids	11/11/2023 12:44 PM

Bitter Lake Reservoir Park & Open Space Project

73	Lots of amenities that can be used year round.	11/10/2023 7:57 PM
74	quiet, restful, peaceful surroundings. Natural vegetation. running water. Shade Reduced street noise	11/10/2023 4:42 PM
75	Children's area away from road. Fences separating street from play area. Adult seating near children's area. Trees and other nature!	11/10/2023 9:36 AM
76	Adequate seating, an abundance of green grass for outdoor meals and lawn chairs can be placed for gatherings.	11/10/2023 8:38 AM
77	well lit, clean, no homeless people living in the park	11/10/2023 7:20 AM
78	Lots of trees and nature, a playground for all ages, no off-leash dogs, no encampments	11/10/2023 6:04 AM
79	Big lawn areas for picnics, something for me and my kid/family to enjoy, walking paths	11/9/2023 9:41 PM
80	Lots of room to walk, lots of things to do, safe when there are a lot of people around and it's clean. Carkeek, Greenwood Park, Discovery	11/9/2023 9:17 PM
81	Stopped going to parks and have been using healthy streets for exercise and meetups. Also Mostly head north to shoreline.	11/9/2023 7:16 PM
82	I like parks that are well lighted at night, have surveillance and security guards onsite.	11/9/2023 12:52 PM
83	Landscape	11/9/2023 3:01 AM
84	Discovery Park, Myrtle Edwards, Golden Gardens. They feel more natural and gentle. Limited or no concrete.	11/8/2023 4:37 PM
85	I can ride to them, through them and be part of a connected bicycle route with the park a good starting point; or place for a break and some conversation etc. Something fun to ride my bicycle through.	11/8/2023 4:04 PM
86	Near water, has pathways or trails, quiet, safe; I like what was done with the Roosevelt reservoir.	11/8/2023 1:53 PM
87	My favorite parks provide a serene atmosphere to relax in nature.	11/8/2023 1:12 PM
88	Maple Leaf Reservoir park. Good walking path. No homeless people, no junkies, no prostitutes make me feel safe.	11/7/2023 8:56 PM
89	Trash receptacles, public restrooms that are clean and maintained, access to water fountains, plenty of area to relax and hangout in nature, nice ambient night time lighting.	11/7/2023 4:49 PM
90	The connection to nature, the trees, the feeling of being away from the "busy city"	11/7/2023 4:21 PM
91	Don't make it too comfy for the homeless to move in and take over, because they will.	11/3/2023 7:28 PM
92	Carkeek Park for its trails, picnic areas and big views Volunteer Park for its many activities and the outdoor amphitheater and summer music. Golden Gardens for the beach, trails, picnicking and views	11/3/2023 4:29 PM
93	Walking through natural setting. Children have a natural place to play. Carkeek, Arboritum, Discovery.	11/3/2023 11:47 AM
94	Hills and trees at different elevations. Meandering paths, places to sit and reflect that are more secluded, but not out of the way dangerous.	11/2/2023 11:38 AM
95	I actually really like the Bitter Lake Reservoir Park! The ropes course is really fun and I'd love to see it expanded upon. It is also pretty accessible as of now--the playground has woodchips which is difficult for folks with mobility aids, but the majority of the space is grass/dirt and paths which are great to walk on with my partner.	11/1/2023 5:54 PM
96	Fun activities like a pump track that engage all ages	11/1/2023 1:35 PM
97	A park that can feel peaceful and quiet and yet still with enough activity and people about that you feel safe. Green lake and the arboretum are the ones one go to the most often.	11/1/2023 1:17 PM
98	Mix of trees and open space. Paths for walking/running. Skate park or flare area for roller skating.	11/1/2023 11:03 AM

Bitter Lake Reservoir Park & Open Space Project

99	Feels like an urban going trail. There's a mix of shade, sun, and topography the space feels more natural and less artificial. There's public art and community gathering spaces. Joaquin Miller Park Oakland, CA	10/31/2023 5:30 PM
100	Favorites: Greenlake, Richmond Beach, Carkeek Likes: Trees and accessibility	10/31/2023 10:45 AM
101	More open areas, and no hidden areas or blind spots. Regular visits from the Parks & Rec maintenance staff.	10/30/2023 8:38 PM
102	Clean, beautiful, homeless free, nature	10/30/2023 5:59 PM
103	The more natural the better (eg trees, plants, open grass). Something for ALL aged kids.	10/29/2023 3:56 PM
104	I love Carkeek and Discovery Park for: Trees, views and walking opportunities. It feels like an oasis in the city. I love how you can connect with nature through wildlife and native plants. I feel safe there when there aren't tents consistently pitched.	10/28/2023 1:49 PM
105	Discovery Park, Hamlin Park. Lots of trails, variety of terrain. People, dog, bike friendly. Parks are maintained, no homeless encampments.	10/28/2023 11:36 AM
106	Lots of open space Clean	10/26/2023 7:21 PM
107	Trees, lots of trees. Pull up bars other fitness equipment	10/26/2023 12:31 PM

Q4 Is there anything else you would like us to consider for the new Bitter Lake Reservoir Park & Open Space?

Answered: 81 Skipped: 73

#	RESPONSES	DATE
1	Find things that don't already exist in the area. Nature play for kids rather than elaborate toy sets.	11/19/2023 8:24 PM
2	When I first moved to the area, I was excited to bear near by a park with a lake. However I didn't realize that the pathway doesn't go all around the lake which has always been disappointing. It would be amazing if a path could be created such that one could circle the lake on a walk or run. I tend to run down the interurban trail behind behind the cemetery instead for this reason. A concern I have, given that there used to be a big issue on the interurban trail behind the cemetery and an encampment right behind Broadview Thompson K-8 school, is that there will still not be a support system for houseless neighbors and those folks might move to the area again.	11/19/2023 3:07 PM
3	Pickleball	11/19/2023 12:51 PM
4	I would love to see quality sand volleyball courts with lights or covering for dark rainy season!	11/18/2023 6:22 PM
5	Beach volleyball courts- I would love to play with my children and friends	11/18/2023 3:01 PM
6	Please consider building sand volleyball courts. This is very popular sport with very little facilities available.	11/18/2023 1:01 PM
7	Sand Volleyball courts with night light or/and roof. Designated Pickleball courts with lights and roof, in order to extend use of space for dark/rainy season.	11/18/2023 10:25 AM
8	Regular security patrols and removal of drug users and campers. NO tolerance policy for these dangers	11/18/2023 9:33 AM
9	Dog parks need to be built w paw washing stations. And .. oyster shells ? Cat tails? Filtering .. magnuson Parking lot is.. Urinetown. Prioritize kids and safety though and don't create / encourage encampment activities (bbq.. showers by playgrounds) you can walk a dog in a street but little kids new safe places to run , play (away from dog poo, traffic, and oh..meth)	11/17/2023 9:16 PM
10	I hope public bathrooms will be available for all, and maintained to be clean and safe and a place to safely dispose of needles. Would be nice to add something like a free library/pantry	11/17/2023 8:33 PM
11	Please keep it safe	11/17/2023 6:03 PM
12	Clean well maintained toilet rooms	11/17/2023 11:16 AM
13	The location near the Interurban Trail makes this a great spot for bike paths and related facilities.	11/15/2023 9:57 PM
14	Dedicated pickleball courts!	11/15/2023 9:39 PM
15	Pickleball is the fastest growing sport in America, accessible to everyone, and a great way to bring communities together!	11/15/2023 2:22 PM
16	Pickleball is an unique sport to encourage because it is one of the few that has the "drop in" nature making it a great activity for people of all ages looking to make new friends and get some exercise. That aspect more than anything else makes providing pickleball courts a top priority in my mind as it encourages friendliness and connections with diverse people. Thank you for your consideration.	11/15/2023 11:41 AM
17	Outdoor Pickleball courts are in high demand and great activity for seniors. Please include!	11/15/2023 8:07 AM
18	Pickleball Courts	11/15/2023 7:43 AM
19	Spray park, connecting the bike trail to the park	11/14/2023 10:09 PM

Bitter Lake Reservoir Park & Open Space Project

20	A splash park please, with expanded summer hours. Our summer weather runs longer/later than the city's current splash park open season dates.	11/14/2023 8:34 PM
21	We do not go there often because the playground is outdated and the area feels very sketchy. Would appreciate significant lighting, security cameras, call boxes, ways to discourage needles and drug paraphernalia from being dumped, barriers to camping overnight, regular neighborhood watch walk-throughs. Concerned for crime, guns, human trafficking due to park's proximity to sketchy areas of Aurora Ave.	11/14/2023 3:32 PM
22	Splash pad	11/14/2023 3:27 PM
23	pickleball court with lights!	11/14/2023 2:26 PM
24	Adding Pickleball to this new area would reduce pressure to convert tennis courts to multi use for tennis and Pickleball.	11/14/2023 2:26 PM
25	SPLASH PARKS ARE AWESOME and a huge community draw!!!	11/14/2023 2:13 PM
26	Adding well lit pickleball courts is a great addition to any new/renovated public park.	11/14/2023 12:49 PM
27	Outdoor pickleball court with lights	11/14/2023 12:36 PM
28	The pickleball community is in need of more courts with lights!	11/14/2023 7:37 AM
29	Pickleball is so busy and crowded. We need more courts please.	11/14/2023 5:59 AM
30	Please make pickleball only courts!!! Trails. Parking space. Thank you for running the survey! ^^	11/13/2023 9:20 PM
31	Lighted dedicated pickleball courts are desperately needed!!!	11/13/2023 8:23 PM
32	Pickleball courts	11/13/2023 8:17 PM
33	An all-weather soccer court would be a great improvement for the many soccer playing families in our neighborhood.	11/13/2023 7:02 PM
34	Pickleball lighting	11/13/2023 5:35 PM
35	Pickleball, dedicated, courts	11/13/2023 2:53 PM
36	We are in dire need of pickleball courts in and around Seattle, preferably outdoor and covered. The sport is growing rapidly, and nobody wants competition between sports like tennis (outdoor) or basketball (indoor) for court space. Let's recognize the need. Most prefer outdoor play due to lighting and traction issues, but a covered court would help with rain, leaves/tree debris, and bright sun.	11/13/2023 2:35 PM
37	Pickleball is the fastest growing sport in America. We need covered, dedicated courts for fall and winter play. Thank you!	11/13/2023 2:20 PM
38	Dedicated outdoor pickleball courts with lights	11/13/2023 1:52 PM
39	Dedicated outdoor pickleball courts with lights	11/13/2023 8:50 AM
40	Lights are a must, and pickleball courts. As many that will fit.	11/13/2023 8:38 AM
41	Pickleball courts!	11/13/2023 8:38 AM
42	Pickleball ball courts	11/13/2023 7:35 AM
43	Security patrol	11/13/2023 7:28 AM
44	Picnic area covered	11/13/2023 7:26 AM
45	Please consider this area for dedicated pickleball courts. We have none in our area and they are needed	11/13/2023 6:59 AM
46	Dedicated pickleball courts and better yet with lights	11/13/2023 5:04 AM
47	Dedicated Pickleball courts 8	11/12/2023 11:20 PM
48	Dedicated lighted pickleball courts	11/12/2023 10:14 PM
49	Pickleball (Washington state game) is an increasingly popular game, and everyone including	11/12/2023 9:46 PM

Bitter Lake Reservoir Park & Open Space Project

children and elderly people can enjoy the game. So please consider creating disunited Pickleball courts there.

50	Safety . No homeless encampments	11/12/2023 9:25 PM
51	Pickleball courts please!	11/12/2023 8:28 PM
52	12 dedicated outdoor pickleball courts with lights	11/12/2023 8:23 PM
53	A dozen dedicated outdoor pickleball courts with lights.	11/12/2023 7:49 PM
54	Make sure that people understand both important programs to the community (based on demographics) and open space (bitter lake one last forested areas in the city. The lake is interesting...and real. Also consider climate change resilience activities. Teach when you can. Try the family BBQ now before committing to it. Set up the opportunity to test this Spring fall...don't just take the "wouldn't it be fun if" we were different people with out 3 jobs and medical conditions! Hire locals!	11/12/2023 9:24 AM
55	Kid friendly space, family friendly space. Paths for all to use. Nature space due to road proximity.	11/11/2023 12:44 PM
56	Charging stations for EVs	11/10/2023 7:57 PM
57	with this particular space you absolutely must plan how to protect the privacy & safety of those households bordering the west side from N 143rd to N 138. This is a unique satin & calls for detailed planning.	11/10/2023 4:42 PM
58	Wading pool or spray features for summer	11/10/2023 9:36 AM
59	No	11/10/2023 8:38 AM
60	Safety features - please consider fencing with smaller gaps that cannot be climbed to help with security and safety for the homes neighboring the park. Please also consider adding more security cameras or devices that will help deter crime or other intrusive behavior. Frequent maintenance/monitoring of any suspicious people or behavior around the park.	11/10/2023 7:20 AM
61	The sensory gardens are really useless. Kids need nature, not the paved paths and horrible hospital blue paint.	11/10/2023 6:04 AM
62	How are you going to keep the park safe? Will it be able to be kept free of tents? Safety should be highest priority.	11/9/2023 7:16 PM
63	Definitely don't like to see off-lease dogs running around the park.	11/9/2023 2:57 PM
64	No	11/9/2023 12:52 PM
65	please keep up the fence on the west side, asit has been a quiet, private road, with no go through! when I go out to get into my car, I want to feel safe.I am concerned that this side of the reservoir, being the secluded side, will become a place for hidden transactions. We bought this house because it is a dead end. We don't want the traffic! On foot or car.	11/9/2023 12:12 PM
66	I live along the west side of the reservoir so I would just ask that the project managers place activity or gathering spaces -away- from this private road so that residents in these homes can maintain some privacy and quiet. I would prefer not to have a dog park, amphitheater, or other loud activity space so close to my front yard. Since other sides of the reservoir have apartments instead of single family residences it seems like these other areas would be best suited to hold activity and gathering spaces anyway.	11/8/2023 1:12 PM
67	No homeless people, no junkies, no prostitutes. Trees.	11/7/2023 8:56 PM
68	Avoid any impacts on P-patch. Increase P-patch garden space.	11/3/2023 7:45 PM
69	Make it harder for people to trash my garden.	11/3/2023 7:28 PM
70	Bathrooms	11/3/2023 4:58 PM
71	I think lots of programing would be great. Also given the concerns about homeless and drug use, include effective lighting, CPTED strategies like open views, lighting and blue phones	11/3/2023 4:29 PM
72	It goes against common sense to put a loud dog park next to the single family residences. Why bring the 1500 apartment dogs over to the west side of the park? If there had to be a dog park put it in the south east corner, Please.	11/3/2023 11:47 AM

Bitter Lake Reservoir Park & Open Space Project

73	There really isn't a safe place for people to skate, bike around here. Bitter Lake community center already has fields and tennis courts but they don't let you skate on them.	11/2/2023 11:38 AM
74	Keep in mind that this is a low-income neighborhood. People are likely to live in the park, and this should be accomadated for--providing trash cans and regularly cleaned restrooms will go a long way in keeping that area safe. It also could be good to have a sharps/biohazards bin in the bathrooms.	11/1/2023 5:54 PM
75	lighting and good sight lines	11/1/2023 1:35 PM
76	I think a perennial edible landscape / food forest could have more of a park/ open space feel than a community garden feel (beacon hill). Integrating the food forest into a landscape park model. Doing this, it would demonstrate edibles and natives in landscape in a sustainable organic way while creating a lovely park to play in and enjoy. Think landscape not garden. Trees like olive, apple, pear, peach, fig, hazelnut, almond, cherry, plum, Saskatoon, elderberry, maybe even banana integrated into a landscape with shrubs like huckleberries, thimbleberries, salmon berry, Oregon grape, blueberries, American cranberries, flowering currants and more. Using ground covers and sustainable practices. It could be called a "picking park". If you have any questions - kippyirwin@gmail.com	11/1/2023 1:17 PM
77	Make the space not feel artificial by removing clean, straight slopes and a manicured "natural area" but expand the p-patch!	10/31/2023 5:30 PM
78	Spray park or water features.	10/30/2023 8:38 PM
79	I would love to see more trees and shaded areas. As our climate changed, it's so important to have space where people can cool off in summer. Right now it's really open, which is nice for recreation, but it feels super hot in summer, especially near the play area.	10/28/2023 1:49 PM
80	I'd like there to be accessible areas that are friendly for people from the adjacent senior housing projects. I'd like the lens for the space as a whole to be expanded living/recreation/relief space for people in the dense housing around it vs being a place people drive to do a thing (big sports courts, zip-lines, etc.)	10/27/2023 1:03 PM
81	What the specific plans in place for when individuals begin to use the new space for permanent camping?	10/26/2023 7:21 PM

Q5 What are the ages of people in your household? (Select all that apply)

Answered: 150 Skipped: 4

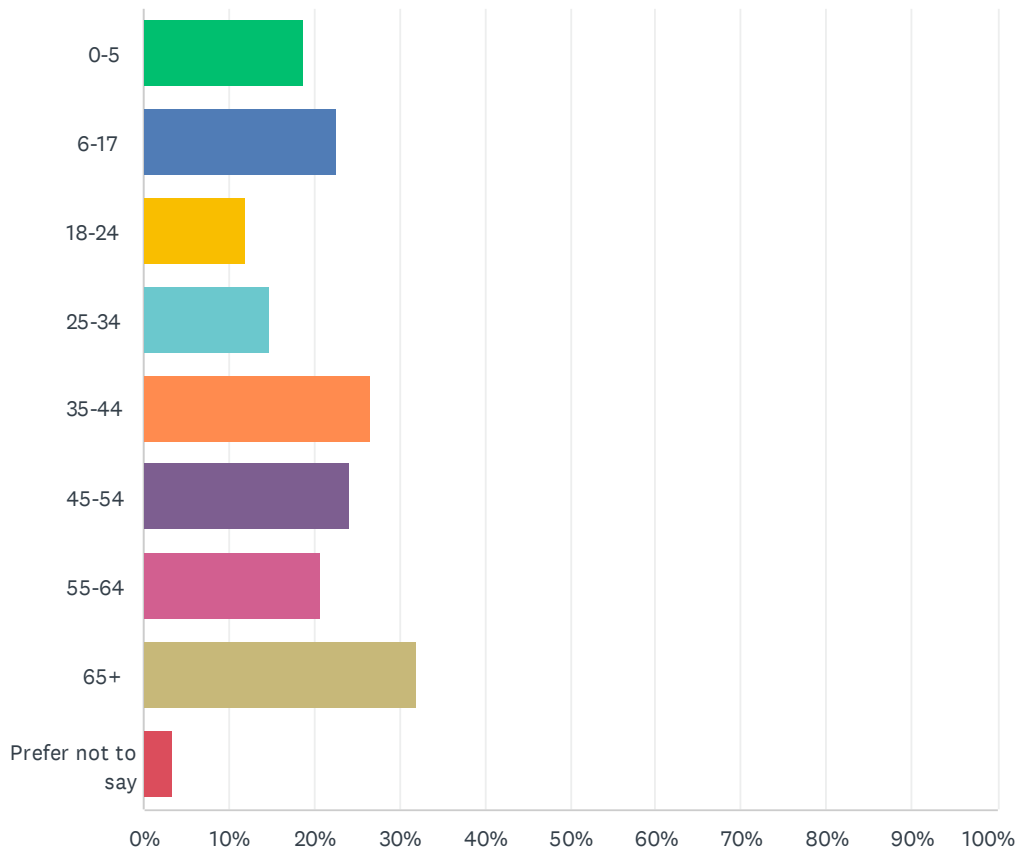

ANSWER CHOICES	RESPONSES	
0-5	18.67%	28
6-17	22.67%	34
18-24	12.00%	18
25-34	14.67%	22
35-44	26.67%	40
45-54	24.00%	36
55-64	20.67%	31
65+	32.00%	48
Prefer not to say	3.33%	5
Total Respondents: 150		

Q6 Choose the racial or ethnic descriptions that you identify with? (Select all that you identify with)

Answered: 146 Skipped: 8

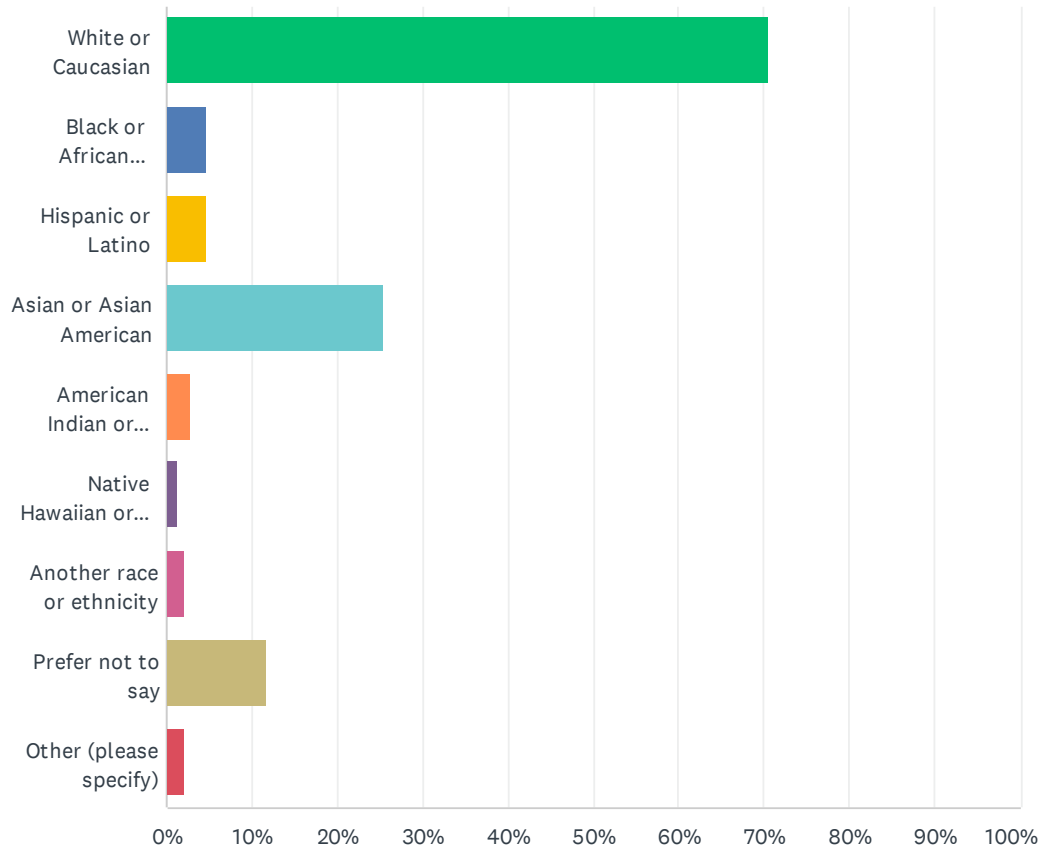

ANSWER CHOICES	RESPONSES	
White or Caucasian	70.55%	103
Black or African American	4.79%	7
Hispanic or Latino	4.79%	7
Asian or Asian American	25.34%	37
American Indian or Alaska Native	2.74%	4
Native Hawaiian or other Pacific Islander	1.37%	2
Another race or ethnicity	2.05%	3
Prefer not to say	11.64%	17
Other (please specify)	2.05%	3
Total Respondents: 146		

#	OTHER (PLEASE SPECIFY)	DATE
---	------------------------	------

Bitter Lake Reservoir Park & Open Space Project

1	Mixed racial	11/18/2023 10:29 AM
2	Human form, colorless , victimless	11/13/2023 7:37 AM
3	Irish American	11/12/2023 10:54 PM

Q7 How are you connected to the community?

Answered: 149 Skipped: 5

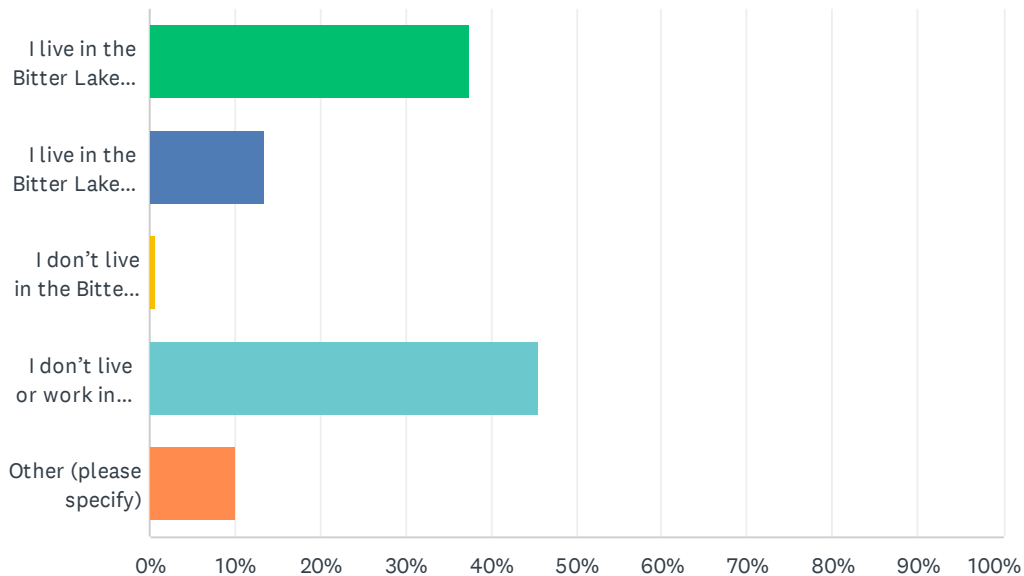

ANSWER CHOICES	RESPONSES	
I live in the Bitter Lake neighborhood and can walk or bike to the park	37.58%	56
I live in the Bitter Lake neighborhood but would likely drive or ride a bus to the park	13.42%	20
I don't live in the Bitter Lake neighborhood, but I work or own a business here	0.67%	1
I don't live or work in Bitter Lake neighborhood but I am a frequent visitor	45.64%	68
Other (please specify)	10.07%	15
Total Respondents: 149		

#	OTHER (PLEASE SPECIFY)	DATE
1	I grew up there, attended Broadview Thomson, and my family frequently visits as my mom still lives there.	11/19/2023 10:55 PM
2	Bitter lake is between my work and my home	11/18/2023 10:29 AM
3	Basic city services and functioning first (infrastructure education SAFETY)	11/17/2023 9:18 PM
4	I do not live there but would visit for the pickleball.	11/15/2023 11:41 AM
5	Play PICKLEBALL there	11/15/2023 7:44 AM
6	I ride my bike past this park about twice a week to get to my post office box and pick stuff up at the Amazon hub. My favorite coffee shop is in the area it's near the place where I volunteer.	11/14/2023 3:28 PM
7	I use the Bitterlake pickleball courts at least 3 times a week.	11/14/2023 5:59 AM
8	I have pickleball friends near there and would visit more often with dedicated pickleball courts	11/13/2023 7:20 AM
9	I live in a home directly adjacent to the reservoir/proposed park expansion.	11/10/2023 7:21 AM
10	I live in Seattle and can bike to the park	11/8/2023 4:05 PM

Bitter Lake Reservoir Park & Open Space Project

11	I live in Haller Lake but often walk by the reservoir.	11/8/2023 1:54 PM
12	I live directly on the west side of the reservoir	11/8/2023 1:13 PM
13	I live about a mile to the SE in Broadview. We don't have a neighborhood park in close walking distance, and so use Bitter Lake fields and courts and community center. I have a dog and grandkids who would use this park.	11/3/2023 4:31 PM
14	I live on Fremont Street, west side of reservoir.	11/3/2023 11:49 AM
15	I live in the near by Haller lake neighborhood.	11/1/2023 1:19 PM